

# Series VB

## Hot Runner Manifolds

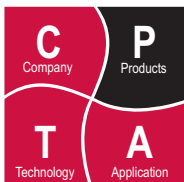
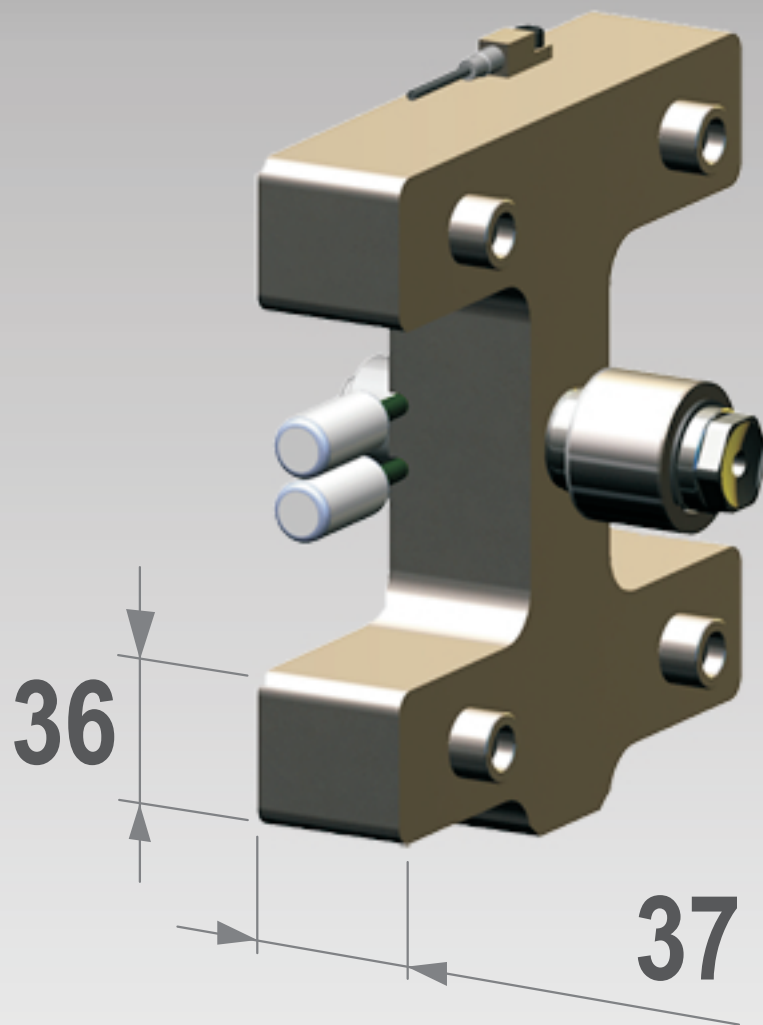

Illustrations simplified, schematically drawn and not to scale.

**Product type**

Hot runner manifold of series **VB** which are characterised by the following dimensions:

- M** Thickness 37 mm
- J2** Flow bore Ø max. Ø10 mm

The manifolds can be supplied in standard shapes (I, H, X, Y) and in any realizable customized shape.

The runners of standard manifolds are mechanically balanced.

**Components**

**Melt flow components**

1. Manifold block including heaters, connections and thermocouple
2. Inlet bushing (including heater)

**Attached parts and accessories**

3. Centre support
4. Dowel
5. Support pad

**Major dimensions (mm)**

- A** Manifold cut out, right (above) 10
- B** Manifold cut out, left (below) 15
- C** Height centre support 15
- E** Height inlet bushing 45/60/100
- De1** Ø of contact inlet bushing Ø24
- De2** Ø of cut out inlet bushing Ø40

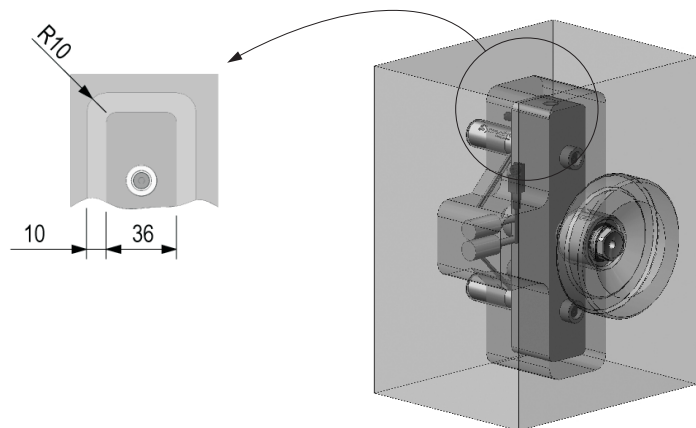
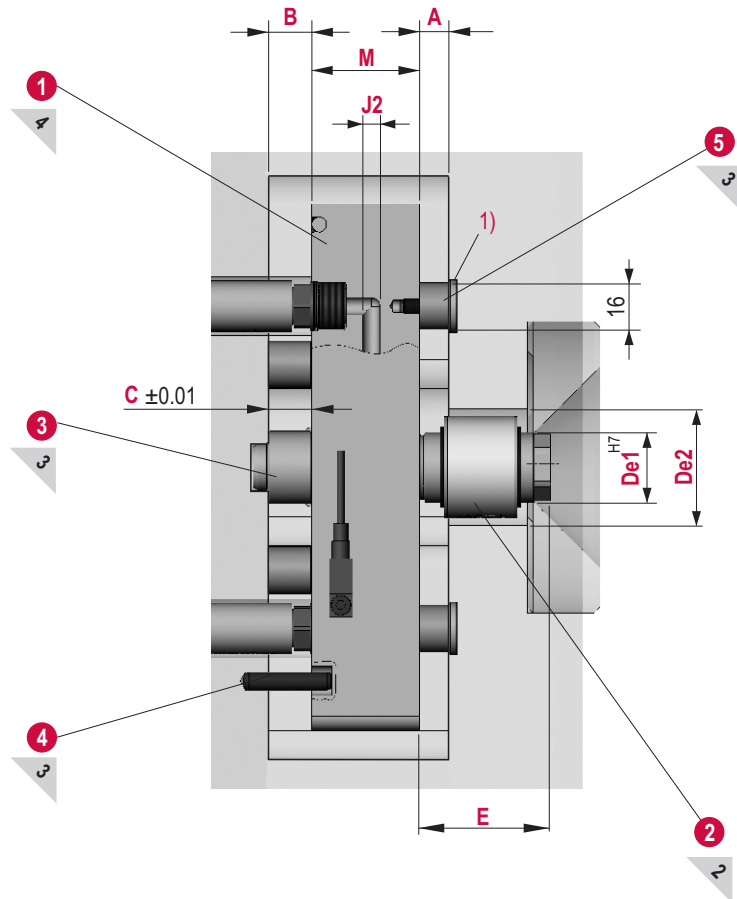

1) Hardened insert recommended; is not supplied with the hot runner system.

Inlet bushings which can be combined with hot runner manifolds of series **VB**:

**1. BC024...045...060...100**

- all length's heated
- threaded into manifold

**Here you can configure your inlet bushing**

[Complete the inlet bushing description](#)

**BC 024**

Part code ↑ Length ↑ R ↑

**Example and explanations**

**BC 024                      060                      16**

Part code ↑ Length code ↑ R ↑

Variables for precise part specification from the drawings and tables shown here

Illustrations simplified, schematically drawn and not to scale.

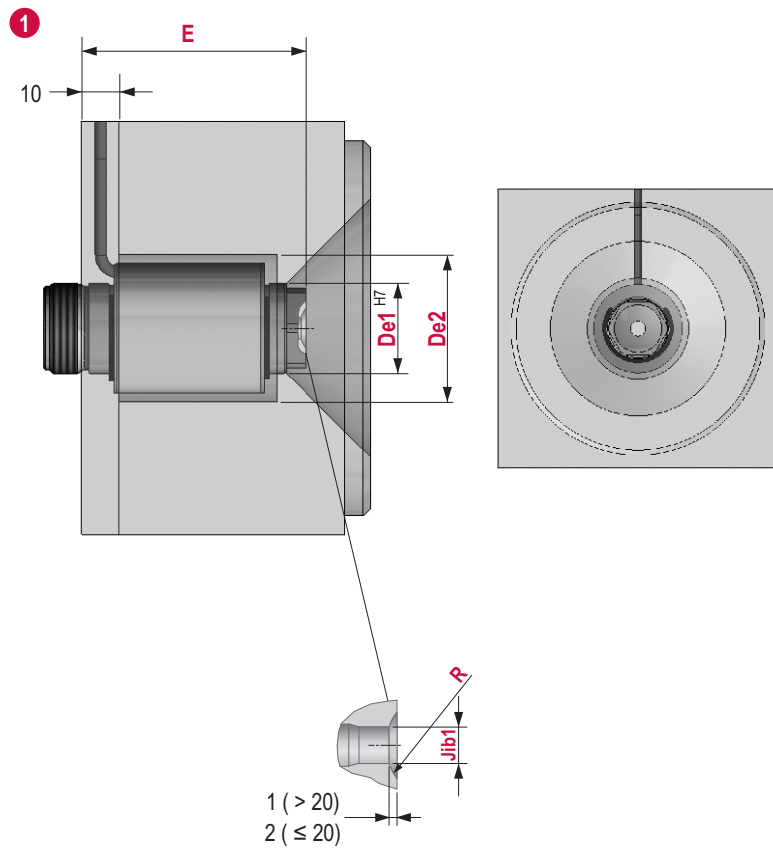

Type	E (mm)	De1 (mm)	De2 (mm)	R (mm)	Jib1 (mm)	-	-	Heater power (Watt)
BC 024045	45	24	40	max. 40	6			140
BC 024060	60	24	40	max. 40	6			180
BC 024100	100	24	40	max. 40	6			250

Attached parts and accessories for hot runner manifolds of series **VB**:

**1. MCS 25 15 01**

Centre support	Lcs (mm)	-
MCS 25 15 01	15	-

**2. SUPPORT PAD**

Support pad	Lms (mm)	-
TP 161001	10	-
TP 161501	15	-

**3. DIN7979: 6 m6**

→ Dowel

Illustrations simplified, schematically drawn and not to scale.

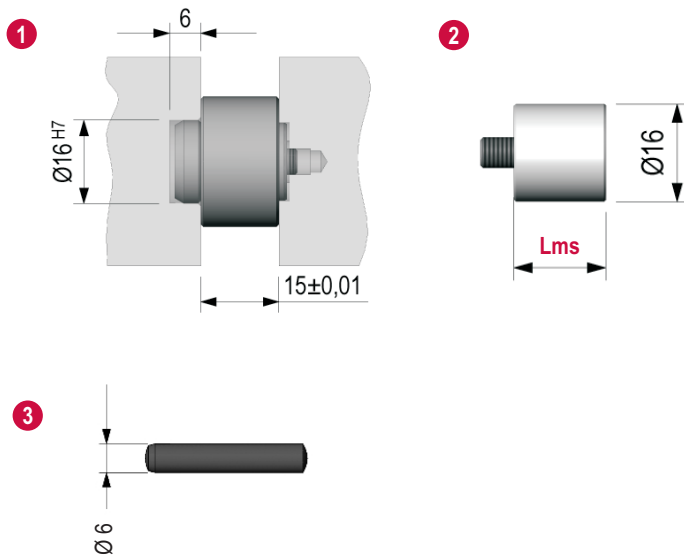
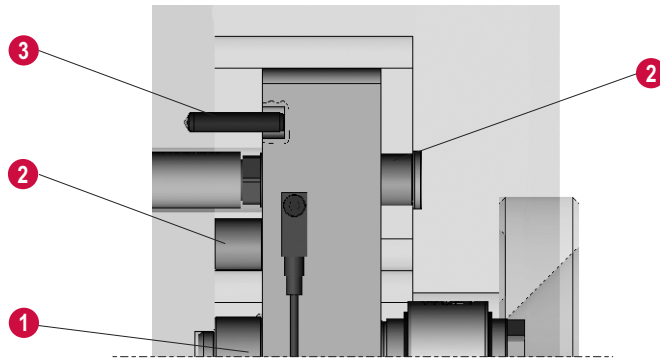

Illustrations simplified, schematically drawn and not to scale.

**1. Manifolds in standard shape**

Manifolds in standard shape have been designed by implementing the standard cavity and runner layouts which are widely used in practice: I, H, X and Y.

Shown on the right there are several examples for manifolds in standard shape based on the components of series **VD**. They are designed and made according to the customer's specification

Using capital letters to describe the different manifold types does not only refer to the shape of the manifold but also to the runner layout inside the manifold. The number represents the number of nozzles attached to the manifold.

**1**

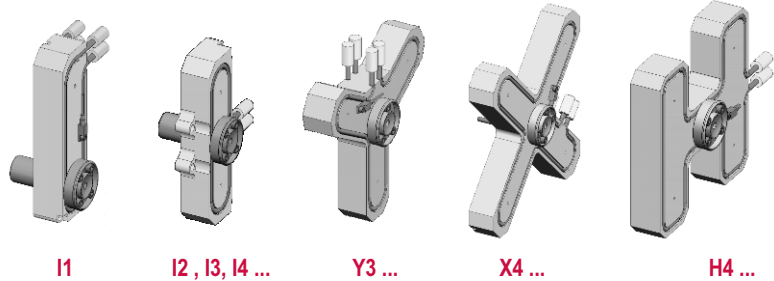

**2. Manifolds in customised shape**

Manifolds in customised shape are designed and made according to the customer's specification by using components of the selected manifold series.

**2**

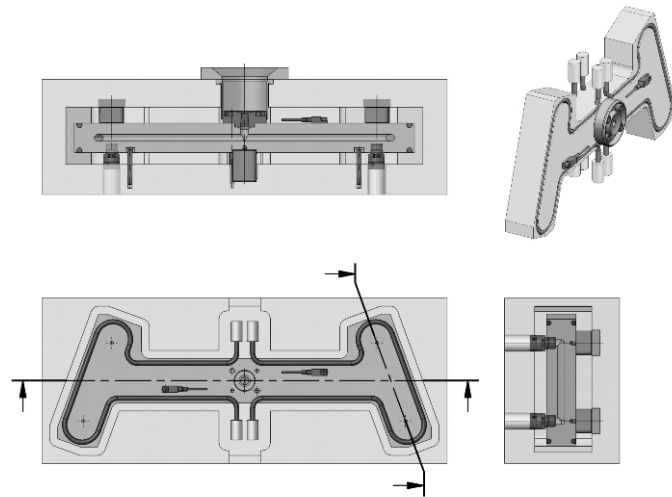

**3. Bridge manifolds**

Bridge manifolds make it possible to combine several manifolds to one feed system. They are designed and made according to the customer's specification by using components of the selected manifold series.

**3**

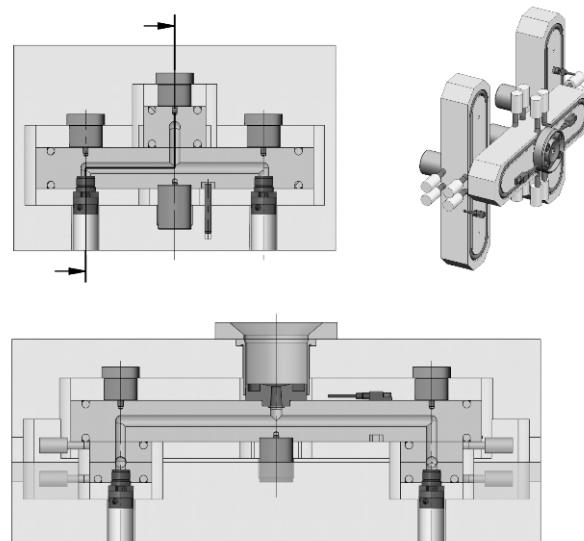

1) Manifold images shown are for example only and are intended for shape visualization only.

[www.synventive.com](http://www.synventive.com)

MK-PRM.BRM.EN-P.IVBMAN 2010-06-16

 **Synventive**  
molding solutions