

Series 03 S01

Single Nozzles, Open

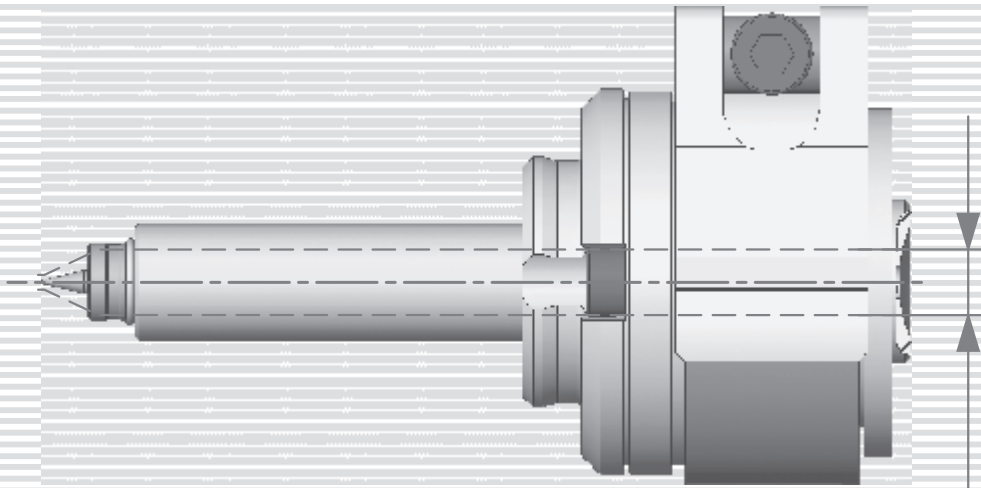

$\varnothing 3$

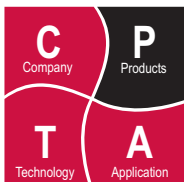

Product type

Hot runner nozzles in the **03 S01** range; this series belongs to nozzle class¹⁾ **03 S**.
 → Nozzle size **03**: Flow bore-Ø 3 mm²⁾
 → Nozzle style **S**: Single nozzle
 → Version **01**: For small nozzle pitch dimensions,

With the nozzle tips in the form of screw-in parts, different nozzle types can be implemented (type = shape and gating of nozzle tip), see table at right.

Available gating types
 → open with torpedo (T)

Major dimensions (mm)

J	Flow bore Ø	Ø3 ²⁾
L	Nozzle length	56...186 ³⁾⁴⁾
D	Ø of cut out, front	Ø14
Dt	Tip Ø	see right
H	Hot runner gate Ø	see right ³⁾
K	Head height	32,2
Dk	Head Ø	Ø45
Ls	Depth of head ring	7
Ds	Ø of head ring	Ø26
R	Radius	max. 40

Heating

- externally heated, 230 V AC
- changeable heater
- 1 zone, 180...280 W
- Fe/CuNi thermocouple, DIN 43710

Application

For all usual thermoplastics
 Max. shot weight per nozzle (g)
 → 10 (open, low viscosity)

☞ page no. of related data sheets

- 1) Enhanced classification for improved ease of selection. Part of the nozzle type No. for later nozzle series.
- 2) Standard value resp. average diameter of nozzle range, can be different depending on nozzle series and application.
- 3) Raster dimensions. Intermediate values can be found from the prescribed dimensional raster.
- 4) Minimum and maximum value of nozzle length depend on the selected tip shape.

Illustrations simplified, schematically drawn and not to scale.

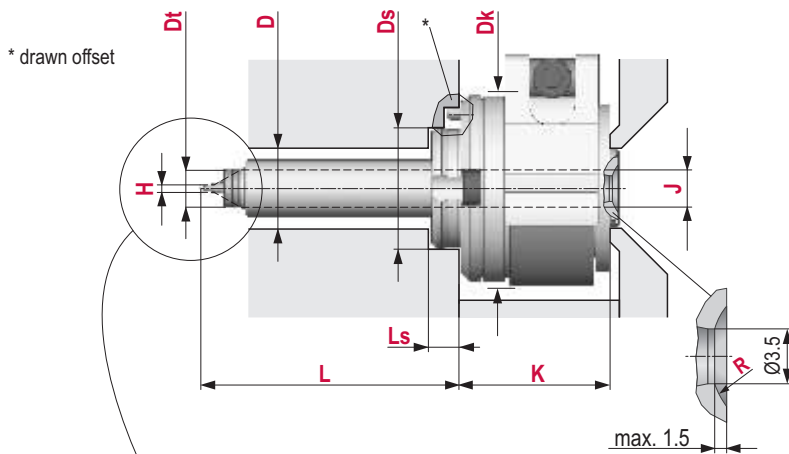

Available nozzle types for this series			
Shape of nozzle tip	Gating of nozzle tip		
	N (open)	T (open with torpedo)	V (valve gate)
Y			
U			
F			
P			
K			
L			
S			
V			
W		 WT H: 0.6...1.2 Dt: Ø8	
X			

Cut out in mould plate for nozzle and connections

Illustrations simplified, schematically drawn and not to scale.

1. Cut out for the nozzle

L Nozzle length

General tolerances: DIN ISO 2768-mK

Surfaces: $\sqrt{3.2} / (\sqrt{1.6})$

Values of the dimension L can be found in the data sheet for the selected nozzle type.

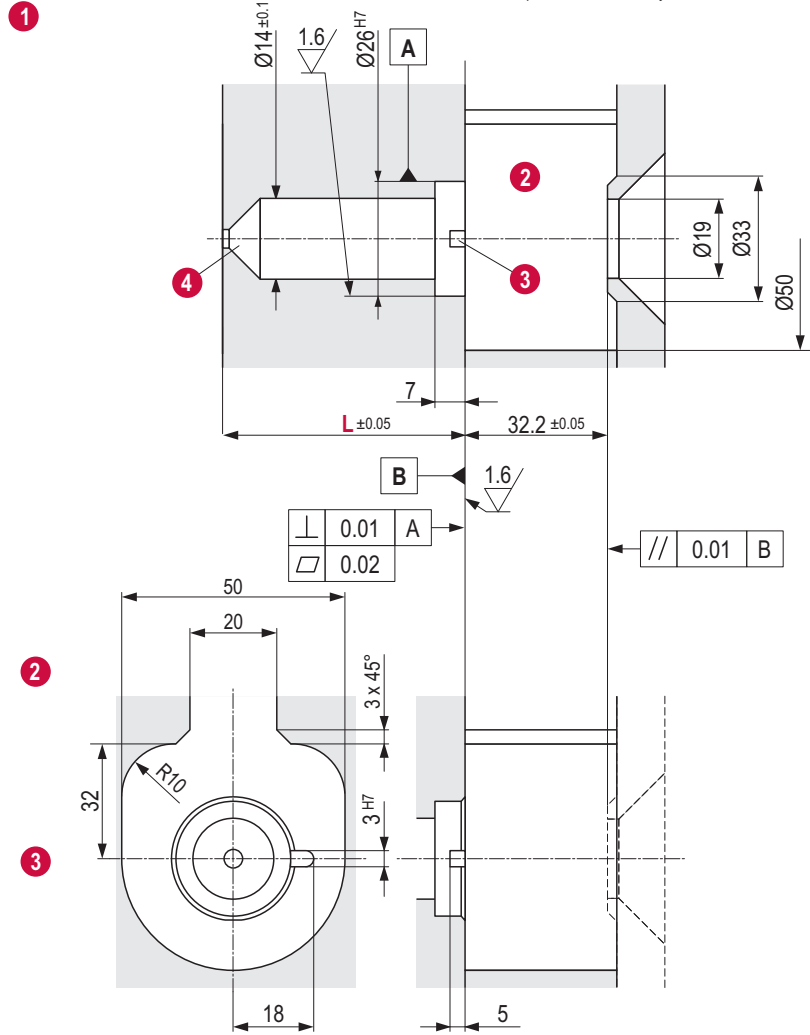

2. Cut out for connections

- electrical power
- thermocouple

3. Bore for locking pin

The locking pin secures the nozzle against rotation.

4. Cut out for the nozzle tip

Blind bore nozzle tip (W, X)

Dt Tip Ø
H Hot runner gate Ø

Depending on the selected nozzle type, different cut outs are required for the nozzle tip.

The dimensions of the cut out for the nozzle tip used can be found in the nozzle data sheet.

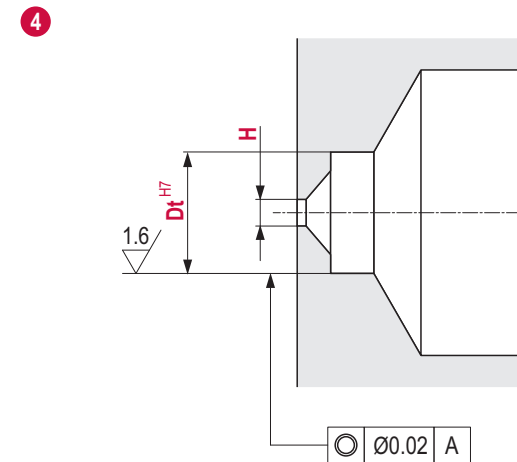

You can configure your nozzle here

1. Complete the nozzle description ¹⁾

03 S01 W02T

Series & Type ↑ Length code ↑

2. Selection of variables

L=↑* H=↑ R=↑

*equal to the value of the length code for this series

Example and explanations

Series ↓ Position in nozzle length chart ²⁾ ↓
03 S01 W02T **056**
 Series & Type ↑ Length code ↑
 ↑ Type ¹⁾

- W Nozzle tip shape W
- 02 Version 02: for materials with medium to wide process window
- T Gating type T: open with torpedo

56 **0.8** **16**
 L=↑ H=↑ R=↑

↑ Variables for precise nozzle specification from the drawings and tables shown here

H (mm)			
0.6	0.8	1.0	1.2

R
max. 40

Illustrations simplified, schematically drawn and not to scale.

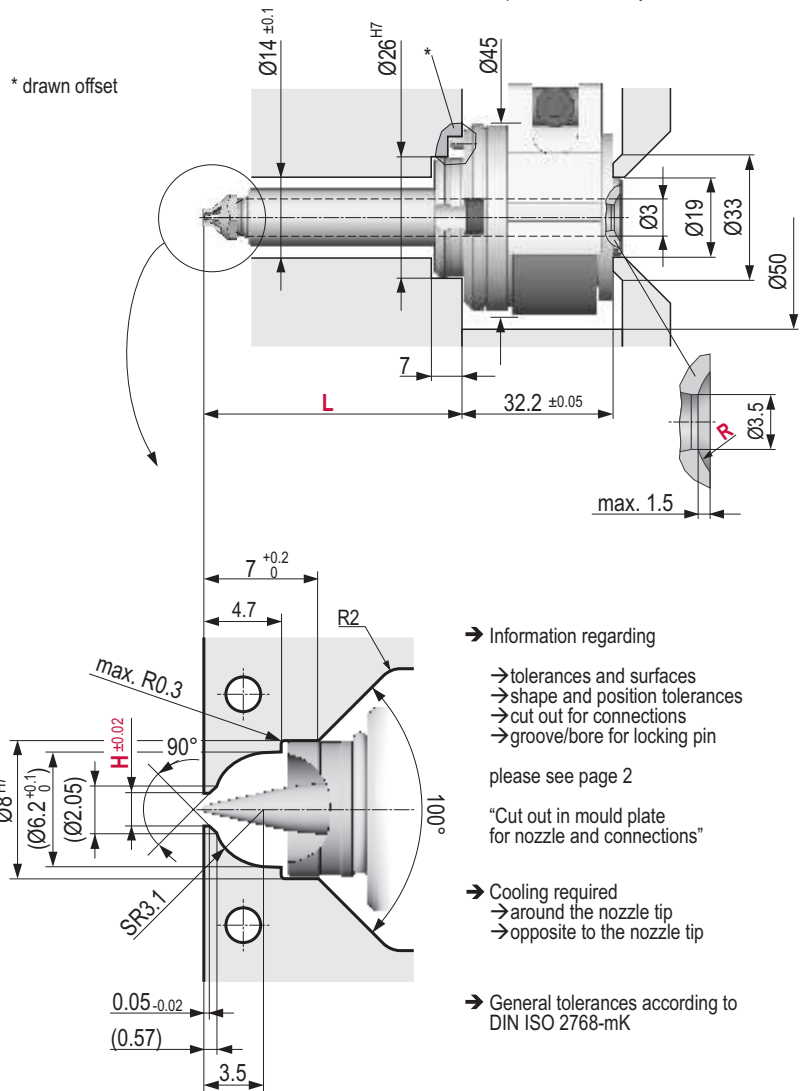

→ Information regarding

- tolerances and surfaces
- shape and position tolerances
- cut out for connections
- groove/bore for locking pin

please see page 2

"Cut out in mould plate for nozzle and connections"

- Cooling required
- around the nozzle tip
- opposite to the nozzle tip

- General tolerances according to DIN ISO 2768-mK

Length code	L (mm)	L1 (mm)	L2 (mm)	Heater zones power ³⁾ (Watt)					1...5
				1	2	3	4	5	
056	56	-	-	180	-	-	-	-	180
066	66	-	-	230	-	-	-	-	230
076	76	-	-	230	-	-	-	-	230
086	86	-	-	230	-	-	-	-	230
096	96	-	-	230	-	-	-	-	230
106	106	-	-	230	-	-	-	-	230
126	126	-	-	230	-	-	-	-	230
146	146	-	-	230	-	-	-	-	230
166	166	-	-	280	-	-	-	-	280
186	186	-	-	280	-	-	-	-	280

1) Nomenclature differences between older and newer nozzle series result from the revision of the nozzle range.
 2) Depending on the nozzle series, the length code corresponds either to a particular nozzle length or to a range of lengths.
 3) The numbering of the heating zones starts at the nozzle tip and ends at the nozzle head.

www.synventive.com

MK-PRM.BRM.GB-P.I03C01 2009-05-01

 **Synventive**
molding solutions