

Series 12 E01

Manifold Nozzles, Screw Fit

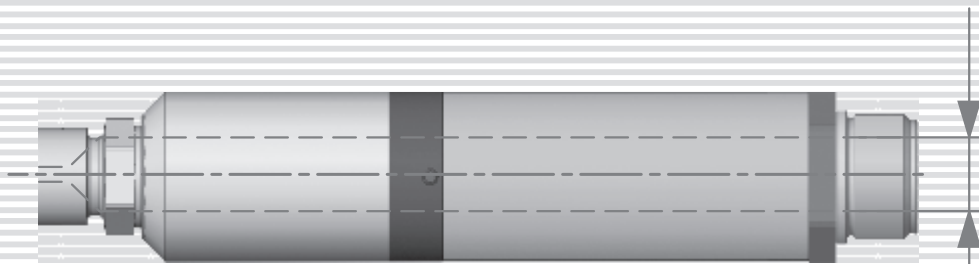

Ø12

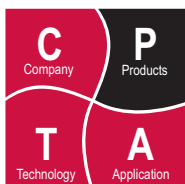

Illustrations simplified, schematically drawn and not to scale.

Product type

Hot runner nozzles in the 12 E01 range; this series belongs to nozzle class¹⁾ 12 E.
 → Nozzle size 12: Flow bore-Ø 12 mm²⁾
 → Nozzle style E: Manifold nozzle, screw fit
 → Version 01: Basic version

With the nozzle tips in the form of screw-in parts, different nozzle types can be implemented (type = shape and gating of nozzle tip), see table at right.

Available gating types

- open (N)
- open with torpedo (T)
- valve gate (V)

Major dimensions (mm)

J	Flow bore Ø	Ø12 ²⁾
L	Nozzle length	96...627 ³⁾⁴⁾
D	Ø of cut out, front	Ø40
Dt	Tip Ø	see right
H	Hot runner gate Ø	see right ³⁾
L1	Length of cut out, back	0 / L-(417...428) ³⁾⁵⁾
D1	Ø of cut out, back	Ø50 ⁵⁾
B	Distance to manifold	20

Heating

- externally heated, 230 V AC
- 1...3 zones, 315...1115 W
- Fe/CuNi thermocouple, DIN 43710

Application

For all usual thermoplastics
 Max. shot weight per nozzle (g)
 → 1500 (open, low viscosity)
 → 500 (valve gate, low viscosity)

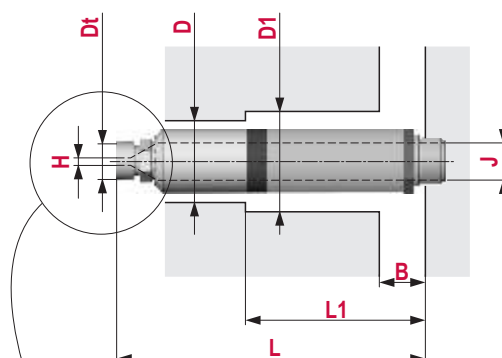

Available nozzle types for this series			
Shape of nozzle tip	Gating of nozzle tip		
	N (open)	T (open with torpedo)	V (valve gate)
Y		YT H: 2.1...3.6 Dt: Ø 16	YV H: 4.0 Dt: Ø 16
U		UT H: 2.1...3.6 Dt: Ø 16	
F			
P		PT H: 2.1...3.6 Dt: Ø 16	
K	KN H: 2.2...4.0 Dt: Ø 20		
L		LT H: 2.1...3.6 Dt: Ø 16	LV H: 4.0 Dt: Ø 16
S		ST H: 2.1...3.6 Dt: Ø 16	SV H: 4.0 Dt: Ø 16
V			VV H: 4.0 Dt: Ø 16
W		WT H: 2.1...3.6 Dt: Ø 16	WV H: 4.0 Dt: Ø 20
X			

⊕ page no. of related data sheets

- 1) Enhanced classification for improved ease of selection. Part of the nozzle type No. for later nozzle series.
- 2) Standard value resp. average diameter of nozzle range, can be different depending on nozzle series and application.
- 3) Raster dimensions. Intermediate values can be found from the prescribed dimensional raster.
- 4) Minimum and maximum value of nozzle length depend on the selected tip shape.
- 5) depending on nozzle length

Illustrations simplified, schematically drawn and not to scale.

1. Cut out for the nozzle

- L Nozzle length
- L1 Length of cut out, back

General tolerances: DIN ISO 2768-mK

Surfaces: $\nabla_{3.2} / \left(\nabla_{1.6} / \nabla_{0.8} \right)$

Values of the dimensions L and L1 can be found in the data sheet for the selected nozzle type.

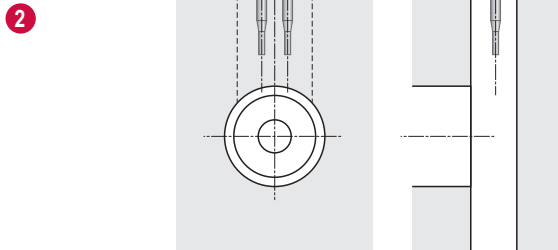
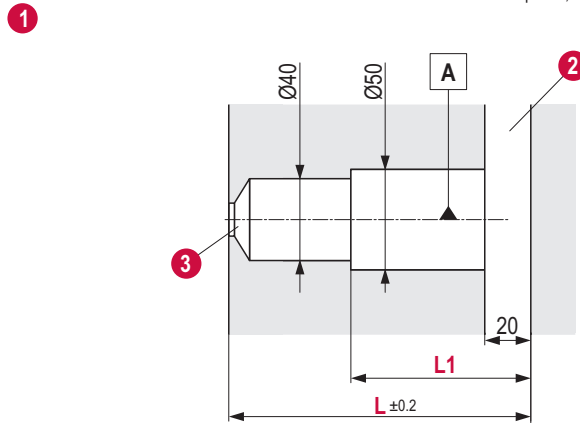

2. Cut out for connections

- electrical power
- thermocouple

3. Groove for locking pin

The locking pin secures the nozzle against rotation.



4. Cut out for the nozzle tip

- a) Through bore nozzle tip (Y...V)
- b) Blind bore nozzle tip (W, X)

- Dt Tip Ø
- H Hot runner gate Ø

Depending on the selected nozzle type, different cut outs are required for the nozzle tip.

The dimensions of the cut out for the nozzle tip used can be found in the nozzle data sheet.

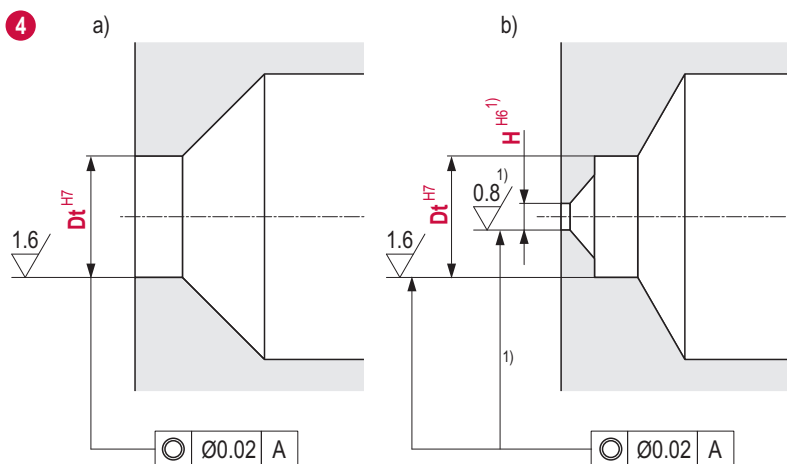

1) These data apply for valve gate nozzles.

Illustrations simplified, schematically drawn and not to scale.

You can configure your nozzle here

1. Complete the nozzle description ¹⁾

12 E01 Y01T

Series & Type ↑ Length code ↑

2. Selection of variables

L=↑* H=↑

*can be chosen within range shown in table below

Example and explanations

Series ↓ Position in nozzle length chart ²⁾ ↓
12 E01 Y01T **096**

Series & Type ↑ Type ¹⁾ ↑ Length code ↑

- Y Nozzle tip shape Y
- 01 Version 01: for materials with narrow to medium process window
- T Gating type T: open with torpedo

112 3.6

L=↑ H=↑

↑ Variables for precise nozzle specification from the drawings and tables shown here

H (mm)					
2.1	2.4	2.7	3.0	3.3	3.6

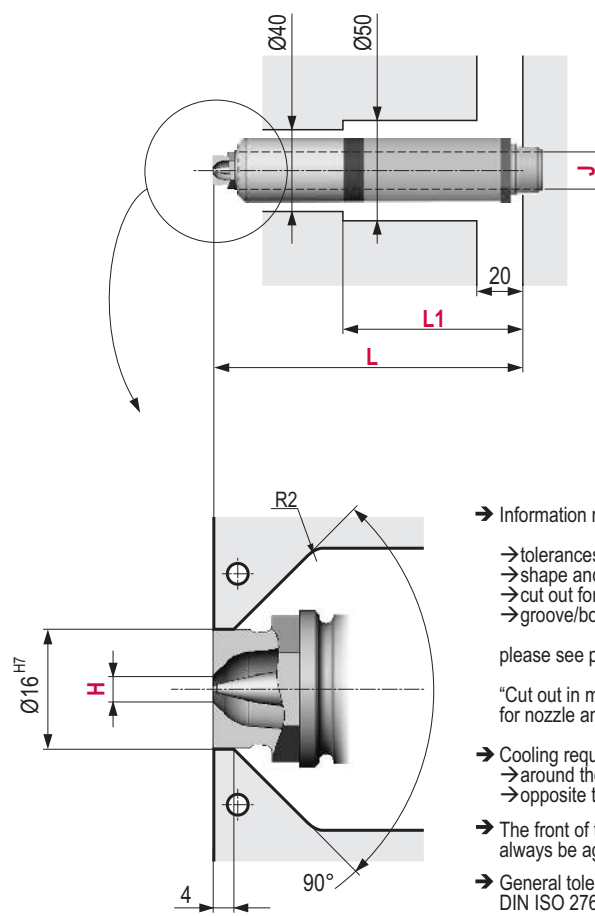

→ Information regarding

- tolerances and surfaces
- shape and position tolerances
- cut out for connections
- groove/bore for locking pin

please see page 2

"Cut out in mould plate for nozzle and connections"

- Cooling required
 - around the nozzle tip
 - opposite to the nozzle tip
- The front of the nozzle tip must always be against plastic.
- General tolerances according to DIN ISO 2768-mK

Length code	L (mm)	L1 (mm)	L2 (mm)	Heater zones power ³⁾ (Watt)					1...5
				1	2	3	4	5	
096	96...115.9	-	-	315	-	-	-	-	315
116	116...135.9	-	-	315	140	-	-	-	455
136	136...155.9	-	-	315	-	-	-	-	315
156	156...175.9	-	-	315	140	-	-	-	455
176	176...195.9	-	-	400	-	-	-	-	400
196	196...215.9	-	-	400	140	-	-	-	540
216	216...255.9	-	-	315	315	-	-	-	630
256	256...295.9	-	-	315	315	-	-	-	630
296	296...335.9	-	-	315	400	-	-	-	715
336	336...375.9	-	-	315	400	-	-	-	715
376	376...415.9	-	-	315	400	180	-	-	895
416	416...455.9	0 / L-417	-	315	400	250	-	-	965
456	456...535.9	L-417	-	315	400	315	-	-	1030
496	496...535.9	L-417	-	315	400	315	-	-	1030
536	536...575.9	L-417	-	315	400	400	-	-	1115
576	576...616	L-417	-	315	400	400	-	-	1115

1) Nomenclature differences between older and newer nozzle series result from the revision of the nozzle range.
 2) Depending on the nozzle series, the length code corresponds either to a particular nozzle length or to a range of lengths.
 3) The numbering of the heating zones starts at the nozzle tip and ends at the nozzle head.

Illustrations simplified, schematically drawn and not to scale.

You can configure your nozzle here

1. Complete the nozzle description ¹⁾

12 E01 Y01V

Series & Type ↑ Length code ↑

2. Selection of variables

L=↑* H=↑

*can be chosen within range shown in table below

Example and explanations

Series ↓ Position in nozzle length chart ²⁾ ↓
12 E01 Y01V **096**
 Series & Type ↑ Length code ↑

Type ¹⁾ ↑

- Y Nozzle tip shape Y
- 01 Version 01: for materials with narrow to medium process window
- V Gating type V: valve gate

112 4.0

L=↑ H=↑

↑ Variables for precise nozzle specification from the drawings and tables shown here

H (mm)
4.0

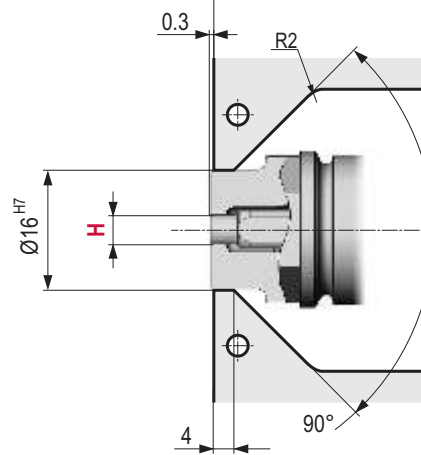
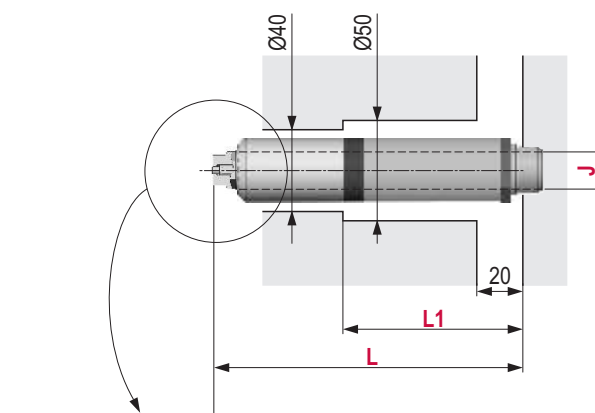

→ Information regarding

- tolerances and surfaces
- shape and position tolerances
- cut out for connections
- groove/bore for locking pin

please see page 2

"Cut out in mould plate for nozzle and connections"

- Cooling required
 - around the nozzle tip
 - opposite to the nozzle tip
- The front of the nozzle tip must always be against plastic.
- General tolerances according to DIN ISO 2768-mK

Length code	L (mm)	L1 (mm)	L2 (mm)	Heater zones power ³⁾ (Watt)					1...5
				1	2	3	4	5	
096	96...115.9	-	-	315	-	-	-	-	315
116	116...135.9	-	-	315	140	-	-	-	455
136	136...155.9	-	-	315	-	-	-	-	315
156	156...175.9	-	-	315	140	-	-	-	455
176	176...195.9	-	-	400	-	-	-	-	400
196	196...215.9	-	-	400	140	-	-	-	540
216	216...255.9	-	-	315	315	-	-	-	630
256	256...295.9	-	-	315	315	-	-	-	630
296	296...335.9	-	-	315	400	-	-	-	715
336	336...375.9	-	-	315	400	-	-	-	715
376	376...415.9	-	-	315	400	180	-	-	895
416	416...455.9	0 / L-417	-	315	400	250	-	-	965
456	456...535.9	L-417	-	315	400	315	-	-	1030
496	496...535.9	L-417	-	315	400	315	-	-	1030
536	536...575.9	L-417	-	315	400	400	-	-	1115
576	576...616	L-417	-	315	400	400	-	-	1115

1) Nomenclature differences between older and newer nozzle series result from the revision of the nozzle range.
 2) Depending on the nozzle series, the length code corresponds either to a particular nozzle length or to a range of lengths.
 3) The numbering of the heating zones starts at the nozzle tip and ends at the nozzle head.

You can configure your nozzle here

1. Complete the nozzle description ¹⁾

12 E01 U01T
Series & Type ↑ Length code ↑

2. Selection of variables

L=↑* H=↑
*can be chosen within range shown in table below

Example and explanations

Series ↓ Position in nozzle length chart ²⁾ ↓
12 E01 U01T **100**
Series & Type ↑ Type ¹⁾ ↑ Length code ↑

- U Nozzle tip shape U
- 01 Version 01: for materials with medium to wide process window
- T Gating type T: open with torpedo

112 3.6
L=↑ H=↑

↑ Variables for precise nozzle specification from the drawings and tables shown here

H (mm)					
2.1	2.4	2.7	3.0	3.3	3.6

1) Nomenclature differences between older and newer nozzle series result from the revision of the nozzle range.
2) Depending on the nozzle series, the length code corresponds either to a particular nozzle length or to a range of lengths.
3) The numbering of the heating zones starts at the nozzle tip and ends at the nozzle head.

Illustrations simplified, schematically drawn and not to scale.

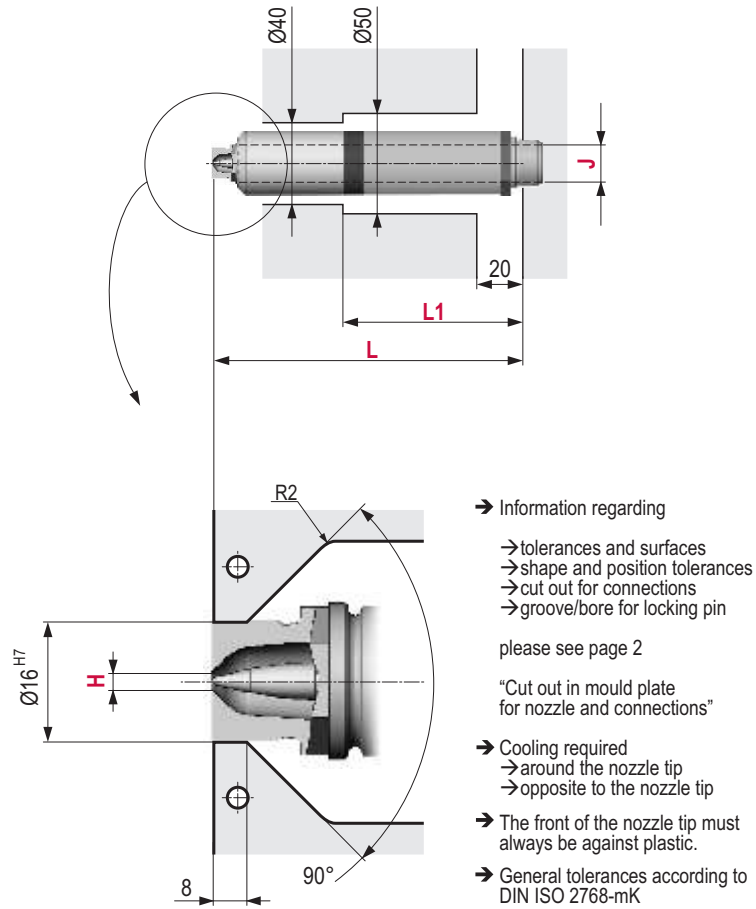

- Information regarding
 - tolerances and surfaces
 - shape and position tolerances
 - cut out for connections
 - groove/bore for locking pin
- please see page 2
- "Cut out in mould plate for nozzle and connections"
- Cooling required
 - around the nozzle tip
 - opposite to the nozzle tip
- The front of the nozzle tip must always be against plastic.
- General tolerances according to DIN ISO 2768-mK

Length code	L (mm)	L1 (mm)	L2 (mm)	Heater zones power ³⁾ (Watt)					1...5
				1	2	3	4	5	
100	100...199.9	-	-	315	-	-	-	-	315
120	120...139.9	-	-	315	140	-	-	-	455
140	140...159.9	-	-	315	-	-	-	-	315
160	159...179.9	-	-	315	140	-	-	-	455
180	180...199.9	-	-	400	-	-	-	-	400
200	200...219.9	-	-	400	140	-	-	-	540
220	220...259.9	-	-	315	315	-	-	-	630
260	260...299.9	-	-	315	315	-	-	-	630
300	300...339.9	-	-	315	400	-	-	-	715
340	340...379.9	-	-	315	400	-	-	-	715
380	380...419.9	-	-	315	400	180	-	-	895
420	420...459.9	0 / L-421	-	315	400	250	-	-	965
460	460...499.9	L-421	-	315	400	315	-	-	1030
500	500...539.9	L-421	-	315	400	315	-	-	1030
540	540...579.9	L-421	-	315	400	400	-	-	1115
580	580...620	L-421	-	315	400	400	-	-	1115

Illustrations simplified, schematically drawn and not to scale.

You can configure your nozzle here

1. Complete the nozzle description ¹⁾

12 E01 P01T

Series & Type ↑ Length code ↑

2. Selection of variables

L=↑* H=↑

*can be chosen within range shown in table below

Example and explanations

Series ↓ Position in nozzle length chart ²⁾ ↓
12 E01 P01T **100**
 Series & Type ↑ Length code ↑

Type ¹⁾ ↑

- P Nozzle tip shape P
- 01 Version 01: for materials with medium to wide process window
- T Gating type T: open with torpedo

112 3.6

L=↑ H=↑

↑ Variables for precise nozzle specification from the drawings and tables shown here

H (mm)					
2.1	2.4	2.7	3.0	3.3	3.6

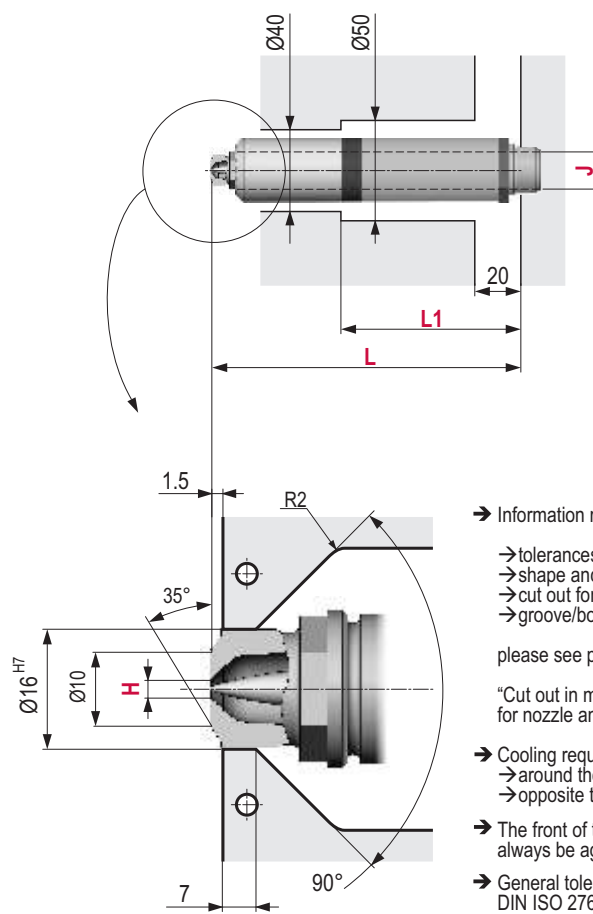

Information regarding

- tolerances and surfaces
- shape and position tolerances
- cut out for connections
- groove/bore for locking pin

please see page 2

"Cut out in mould plate for nozzle and connections"

- Cooling required
 - around the nozzle tip
 - opposite to the nozzle tip
- The front of the nozzle tip must always be against plastic.
- General tolerances according to DIN ISO 2768-mK

Length code	L (mm)	L1 (mm)	L2 (mm)	Heater zones power ³⁾ (Watt)					
				1	2	3	4	5	1...5
100	100...199.9	-	-	315	-	-	-	-	315
120	120...139.9	-	-	315	140	-	-	-	455
140	140...159.9	-	-	315	-	-	-	-	315
160	159...179.9	-	-	315	140	-	-	-	455
180	180...199.9	-	-	400	-	-	-	-	400
200	200...219.9	-	-	400	140	-	-	-	540
220	220...259.9	-	-	315	315	-	-	-	630
260	260...299.9	-	-	315	315	-	-	-	630
300	300...339.9	-	-	315	400	-	-	-	715
340	340...379.9	-	-	315	400	-	-	-	715
380	380...419.9	-	-	315	400	180	-	-	895
420	420...459.9	0 / L-421	-	315	400	250	-	-	965
460	460...499.9	L-421	-	315	400	315	-	-	1030
500	500...539.9	L-421	-	315	400	315	-	-	1030
540	540...579.9	L-421	-	315	400	400	-	-	1115
580	580...620	L-421	-	315	400	400	-	-	1115

1) Nomenclature differences between older and newer nozzle series result from the revision of the nozzle range.
 2) Depending on the nozzle series, the length code corresponds either to a particular nozzle length or to a range of lengths.
 3) The numbering of the heating zones starts at the nozzle tip and ends at the nozzle head.

You can configure your nozzle here

1. Complete the nozzle description ¹⁾

12 E01 K01N
Series & Type ↑ Length code ↑

2. Selection of variables

L=↑* H=↑ F=↑
*can be chosen within range shown in table below

Example and explanations

Series ↓ Position in nozzle length chart ²⁾ ↓
12 E01 K01N **100**
Series & Type ↑ Type ¹⁾ ↑ Length code ↑

- K Nozzle tip shape K
- 01 Version 01: for all usual thermoplastics
- N Gating type N: open

112 3.6 30
L=↑ H=↑ F=↑

↑ Variables for precise nozzle specification from the drawings and tables shown here

H (mm)					
2.2	2.5	2.8	3.2	3.6	4.0

F (mm)					
0	5	30	50	70	90

F = 0...50	G (°)	F = 70 / 90
3		1.5

- 1) Nomenclature differences between older and newer nozzle series result from the revision of the nozzle range.
- 2) Depending on the nozzle series, the length code corresponds either to a particular nozzle length or to a range of lengths.
- 3) The numbering of the heating zones starts at the nozzle tip and ends at the nozzle head.

Illustrations simplified, schematically drawn and not to scale.

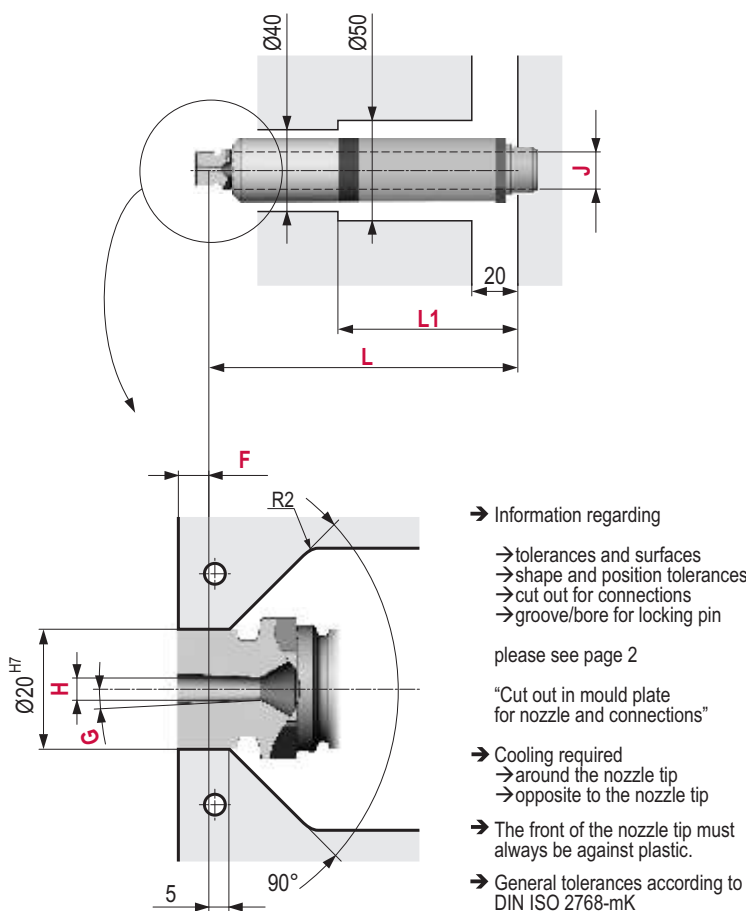

- Information regarding
 - tolerances and surfaces
 - shape and position tolerances
 - cut out for connections
 - groove/bore for locking pin
- please see page 2
- "Cut out in mould plate for nozzle and connections"
- Cooling required
 - around the nozzle tip
 - opposite to the nozzle tip
- The front of the nozzle tip must always be against plastic.
- General tolerances according to DIN ISO 2768-mK

Length code	L (mm)	L1 (mm)	L2 (mm)	Heater zones power ³⁾ (Watt)					
				1	2	3	4	5	1...5
100	100...199.9	-	-	315	-	-	-	-	315
120	120...139.9	-	-	315	140	-	-	-	455
140	140...159.9	-	-	315	-	-	-	-	315
160	159...179.9	-	-	315	140	-	-	-	455
180	180...199.9	-	-	400	-	-	-	-	400
200	200...219.9	-	-	400	140	-	-	-	540
220	220...259.9	-	-	315	315	-	-	-	630
260	260...299.9	-	-	315	315	-	-	-	630
300	300...339.9	-	-	315	400	-	-	-	715
340	340...379.9	-	-	315	400	-	-	-	715
380	380...419.9	-	-	315	400	180	-	-	895
420	420...459.9	0 / L-421	-	315	400	250	-	-	965
460	460...499.9	L-421	-	315	400	315	-	-	1030
500	500...539.9	L-421	-	315	400	315	-	-	1030
540	540...579.9	L-421	-	315	400	400	-	-	1115
580	580...620	L-421	-	315	400	400	-	-	1115

Illustrations simplified, schematically drawn and not to scale.

You can configure your nozzle here

1. Complete the nozzle description ¹⁾

12 E01 L01T

Series & Type ↑ Length code ↑

2. Selection of variables

L=↑* H=↑ F=↑

*can be chosen within range shown in table below

Example and explanations

Series ↓ Position in nozzle length chart ²⁾ ↓
12 E01 L01T **096**

Series & Type ↑ Type ¹⁾ ↑ Length code ↑

- L Nozzle tip shape L
- 01 Version 01: for materials with narrow to medium process window
- T Gating type T: open with torpedo

112 3.6 15

L=↑ H=↑ F=↑

↑ Variables for precise nozzle specification from the drawings and tables shown here

H (mm)					
2.1	2.4	2.7	3.0	3.3	3.6

F (mm)	
15	50

G (°)
3

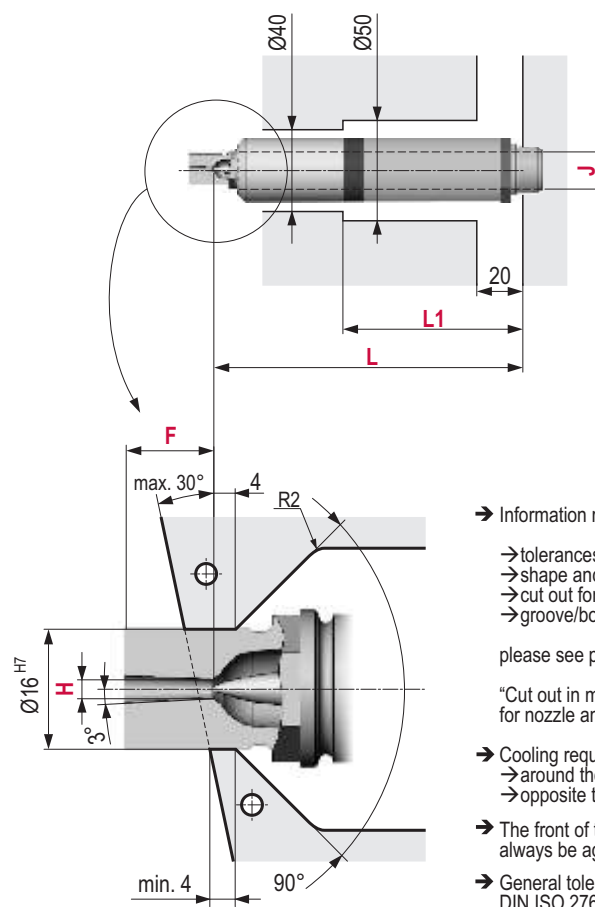

Information regarding

- tolerances and surfaces
- shape and position tolerances
- cut out for connections
- groove/bore for locking pin

please see page 2

"Cut out in mould plate for nozzle and connections"

- Cooling required
 - around the nozzle tip
 - opposite to the nozzle tip
- The front of the nozzle tip must always be against plastic.
- General tolerances according to DIN ISO 2768-mK

Length code	L (mm)	L1 (mm)	L2 (mm)	Heater zones power ³⁾ (Watt)					1...5
				1	2	3	4	5	
096	96...115.9	-	-	315	-	-	-	-	315
116	116...135.9	-	-	315	140	-	-	-	455
136	136...155.9	-	-	315	-	-	-	-	315
156	156...175.9	-	-	315	140	-	-	-	455
176	176...195.9	-	-	400	-	-	-	-	400
196	196...215.9	-	-	400	140	-	-	-	540
216	216...255.9	-	-	315	315	-	-	-	630
256	256...295.9	-	-	315	315	-	-	-	630
296	296...335.9	-	-	315	400	-	-	-	715
336	336...375.9	-	-	315	400	-	-	-	715
376	376...415.9	-	-	315	400	180	-	-	895
416	416...455.9	0 / L-417	-	315	400	250	-	-	965
456	456...535.9	L-417	-	315	400	315	-	-	1030
496	496...535.9	L-417	-	315	400	315	-	-	1030
536	536...575.9	L-417	-	315	400	400	-	-	1115
576	576...616	L-417	-	315	400	400	-	-	1115

1) Nomenclature differences between older and newer nozzle series result from the revision of the nozzle range.
 2) Depending on the nozzle series, the length code corresponds either to a particular nozzle length or to a range of lengths.
 3) The numbering of the heating zones starts at the nozzle tip and ends at the nozzle head.

You can configure your nozzle here

1. Complete the nozzle description ¹⁾

12 E01 L01V
Series & Type ↑ Length code ↑

2. Selection of variables

L=↑* H=↑ F=↑
*can be chosen within range shown in table below

Example and explanations

Series ↓ Position in nozzle length chart ²⁾ ↓
12 E01 L01V **096**
Series & Type ↑ Type ¹⁾ ↑ Length code ↑

- L Nozzle tip shape L
- 01 Version 01: for materials with narrow to medium process window
- V Gating type V: valve gate

112 4.0 15
L=↑ H=↑ F=↑

↑ Variables for precise nozzle specification from the drawings and tables shown here

H (mm)
4.0

F (mm)
15 50

G (°)
3

- 1) Nomenclature differences between older and newer nozzle series result from the revision of the nozzle range.
- 2) Depending on the nozzle series, the length code corresponds either to a particular nozzle length or to a range of lengths.
- 3) The numbering of the heating zones starts at the nozzle tip and ends at the nozzle head.

Illustrations simplified, schematically drawn and not to scale.

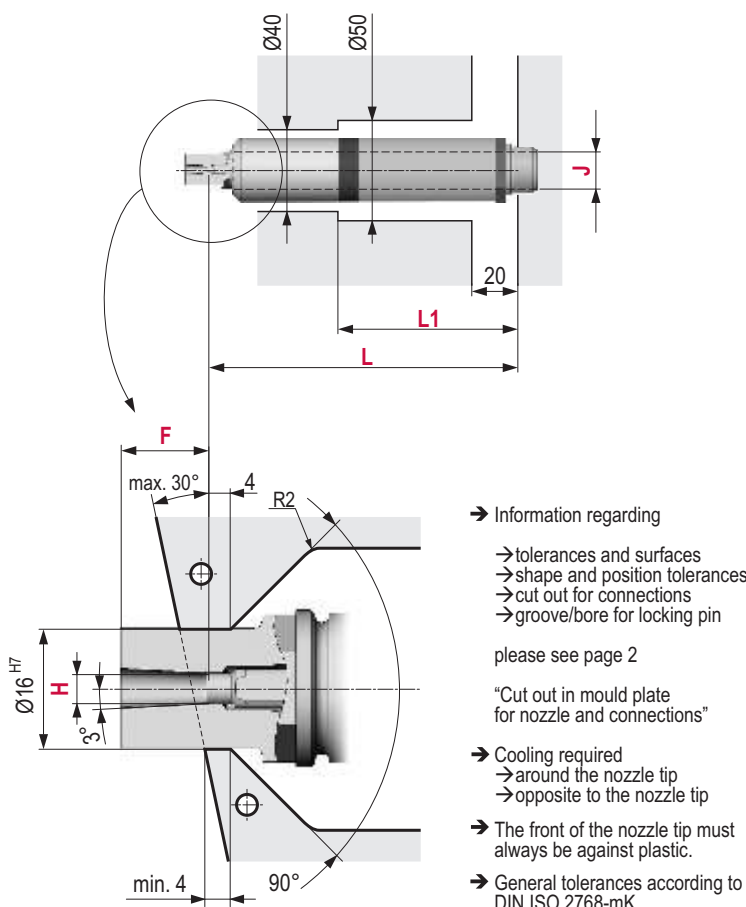

- Information regarding
 - tolerances and surfaces
 - shape and position tolerances
 - cut out for connections
 - groove/bore for locking pin
- please see page 2
- "Cut out in mould plate for nozzle and connections"
- Cooling required
 - around the nozzle tip
 - opposite to the nozzle tip
- The front of the nozzle tip must always be against plastic.
- General tolerances according to DIN ISO 2768-mK

Length code	L (mm)	L1 (mm)	L2 (mm)	Heater zones power ³⁾ (Watt)					1...5
				1	2	3	4	5	
096	96...115.9	-	-	315	-	-	-	-	315
116	116...135.9	-	-	315	140	-	-	-	455
136	136...155.9	-	-	315	-	-	-	-	315
156	156...175.9	-	-	315	140	-	-	-	455
176	176...195.9	-	-	400	-	-	-	-	400
196	196...215.9	-	-	400	140	-	-	-	540
216	216...255.9	-	-	315	315	-	-	-	630
256	256...295.9	-	-	315	315	-	-	-	630
296	296...335.9	-	-	315	400	-	-	-	715
336	336...375.9	-	-	315	400	-	-	-	715
376	376...415.9	-	-	315	400	180	-	-	895
416	416...455.9	0 / L-417	-	315	400	250	-	-	965
456	456...535.9	L-417	-	315	400	315	-	-	1030
496	496...535.9	L-417	-	315	400	315	-	-	1030
536	536...575.9	L-417	-	315	400	400	-	-	1115
576	576...616	L-417	-	315	400	400	-	-	1115

Illustrations simplified, schematically drawn and not to scale.

You can configure your nozzle here

1. Complete the nozzle description ¹⁾

12 E01 S01T

Series & Type ↑ Length code ↑

2. Selection of variables

L=↑* H=↑ F=↑

*can be chosen within range shown in table below

Example and explanations

Series ↓ Position in nozzle length chart ²⁾ ↓
12 E01 S01T **100**

Series & Type ↑ Type ¹⁾ ↑ Length code ↑

- S Nozzle tip shape S
- 01 Version 01: for materials with medium to wide process window
- T Gating type T: open with torpedo

112 3.6 15

L=↑ H=↑ F=↑

↑ Variables for precise nozzle specification from the drawings and tables shown here

H (mm)					
2.1	2.4	2.7	3.0	3.3	3.6

F (mm)	
15	50

G (°)
3

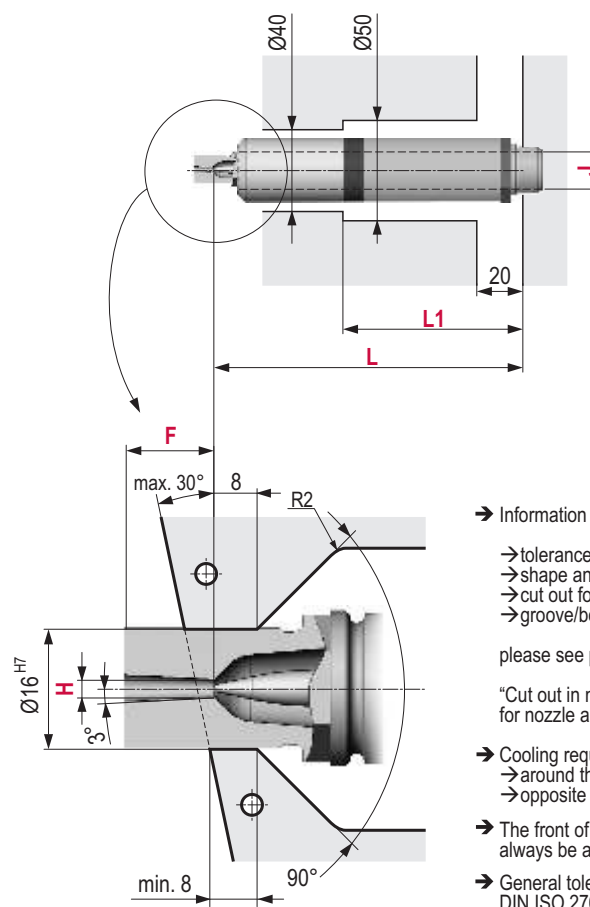

Information regarding

- tolerances and surfaces
- shape and position tolerances
- cut out for connections
- groove/bore for locking pin

please see page 2

"Cut out in mould plate for nozzle and connections"

- Cooling required
 - around the nozzle tip
 - opposite to the nozzle tip
- The front of the nozzle tip must always be against plastic.
- General tolerances according to DIN ISO 2768-mK

Length code	L (mm)	L1 (mm)	L2 (mm)	Heater zones power ³⁾ (Watt)					1...5
				1	2	3	4	5	
100	100...199.9	-	-	315	-	-	-	-	315
120	120...139.9	-	-	315	140	-	-	-	455
140	140...159.9	-	-	315	-	-	-	-	315
160	159...179.9	-	-	315	140	-	-	-	455
180	180...199.9	-	-	400	-	-	-	-	400
200	200...219.9	-	-	400	140	-	-	-	540
220	220...259.9	-	-	315	315	-	-	-	630
260	260...299.9	-	-	315	315	-	-	-	630
300	300...339.9	-	-	315	400	-	-	-	715
340	340...379.9	-	-	315	400	-	-	-	715
380	380...419.9	-	-	315	400	180	-	-	895
420	420...459.9	0 / L-421	-	315	400	250	-	-	965
460	460...499.9	L-421	-	315	400	315	-	-	1030
500	500...539.9	L-421	-	315	400	315	-	-	1030
540	540...579.9	L-421	-	315	400	400	-	-	1115
580	580...620	L-421	-	315	400	400	-	-	1115

1) Nomenclature differences between older and newer nozzle series result from the revision of the nozzle range.
 2) Depending on the nozzle series, the length code corresponds either to a particular nozzle length or to a range of lengths.
 3) The numbering of the heating zones starts at the nozzle tip and ends at the nozzle head.

Illustrations simplified, schematically drawn and not to scale.

You can configure your nozzle here

1. Complete the nozzle description ¹⁾

12 E01 S01V

Series & Type ↑ Length code ↑

2. Selection of variables

L=↑* H=↑ F=↑

*can be chosen within range shown in table below

Example and explanations

Series ↓ Position in nozzle length chart ²⁾ ↓
12 E01 S01V **100**
 Series & Type ↑ Length code ↑
 Type ¹⁾ ↑

- S Nozzle tip shape S
- 01 Version 01: for materials with medium to wide process window
- V Gating type V: valve gate

112 4.0 15
 L=↑ H=↑ F=↑

↑ Variables for precise nozzle specification from the drawings and tables shown here

H (mm)	
4.0	
F (mm)	
15	50
G (°)	
3	

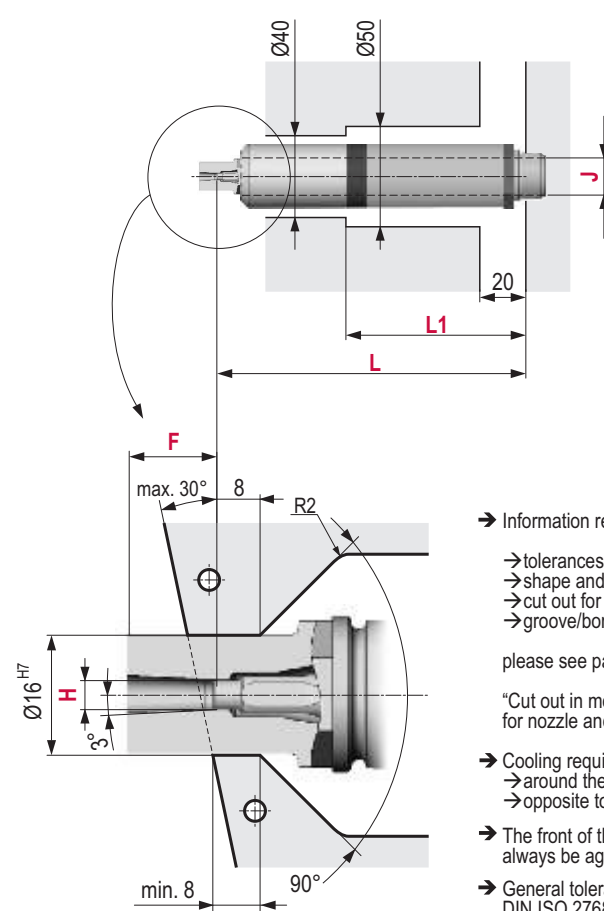

- Information regarding
 - tolerances and surfaces
 - shape and position tolerances
 - cut out for connections
 - groove/bore for locking pin
- please see page 2
- "Cut out in mould plate for nozzle and connections"
- Cooling required
 - around the nozzle tip
 - opposite to the nozzle tip
- The front of the nozzle tip must always be against plastic.
- General tolerances according to DIN ISO 2768-mK

Length code	L (mm)	L1 (mm)	L2 (mm)	Heater zones power ³⁾ (Watt)					1...5
				1	2	3	4	5	
100	100...199.9	-	-	315	-	-	-	-	315
120	120...139.9	-	-	315	140	-	-	-	455
140	140...159.9	-	-	315	-	-	-	-	315
160	159...179.9	-	-	315	140	-	-	-	455
180	180...199.9	-	-	400	-	-	-	-	400
200	200...219.9	-	-	400	140	-	-	-	540
220	220...259.9	-	-	315	315	-	-	-	630
260	260...299.9	-	-	315	315	-	-	-	630
300	300...339.9	-	-	315	400	-	-	-	715
340	340...379.9	-	-	315	400	-	-	-	715
380	380...419.9	-	-	315	400	180	-	-	895
420	420...459.9	0 / L-421	-	315	400	250	-	-	965
460	460...499.9	L-421	-	315	400	315	-	-	1030
500	500...539.9	L-421	-	315	400	315	-	-	1030
540	540...579.9	L-421	-	315	400	400	-	-	1115
580	580...620	L-421	-	315	400	400	-	-	1115

1) Nomenclature differences between older and newer nozzle series result from the revision of the nozzle range.
 2) Depending on the nozzle series, the length code corresponds either to a particular nozzle length or to a range of lengths.
 3) The numbering of the heating zones starts at the nozzle tip and ends at the nozzle head.

Illustrations simplified, schematically drawn and not to scale.

You can configure your nozzle here

1. Complete the nozzle description ¹⁾

12 E01 V01V

Series & Type ↑ Length code ↑

2. Selection of variables

L=↑* H=↑ F=↑

*can be chosen within range shown in table below

Example and explanations

Series ↓ Position in nozzle length chart ²⁾ ↓
12 E01 V01V **107**

Series & Type ↑ Type ¹⁾ ↑ Length code ↑

- V Nozzle tip shape V
- 01 Version 01: for materials with medium to wide process window
- V Gating type V: valve gate

112 4.0 15

L=↑ H=↑ F=↑

↑ Variables for precise nozzle specification from the drawings and tables shown here

H (mm)	
4.0	

F (mm)				
0	15	30	50	90

F = 0 / 15 / 30	G (°)	F = 50 / 90
3		1.5

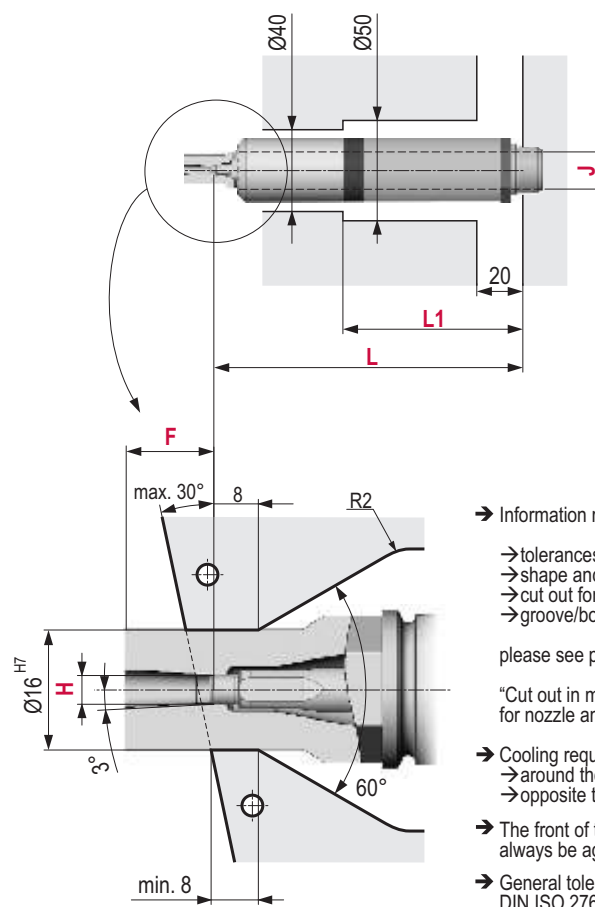

Information regarding

- tolerances and surfaces
- shape and position tolerances
- cut out for connections
- groove/bore for locking pin

please see page 2

"Cut out in mould plate for nozzle and connections"

- Cooling required
 - around the nozzle tip
 - opposite to the nozzle tip
- The front of the nozzle tip must always be against plastic.
- General tolerances according to DIN ISO 2768-mK

Length code	L (mm)	L1 (mm)	L2 (mm)	Heater zones power ³⁾ (Watt)					1...5
				1	2	3	4	5	
107	107...126.9	-	-	315	-	-	-	-	315
127	127...146.9	-	-	315	140	-	-	-	455
147	147...166.9	-	-	315	-	-	-	-	315
167	167...186.9	-	-	315	140	-	-	-	455
187	187...206.9	-	-	400	-	-	-	-	400
207	207...226.9	-	-	400	140	-	-	-	540
227	227...266.9	-	-	315	315	-	-	-	630
267	267...306.9	-	-	315	315	-	-	-	630
307	307...346.9	-	-	315	400	-	-	-	715
347	347...386.9	-	-	315	400	-	-	-	715
387	387...426.9	-	-	315	400	180	-	-	895
427	427...466.9	0 / L-428	-	315	400	250	-	-	965
467	467...506.9	L-428	-	315	400	315	-	-	1030
507	507...546.9	L-428	-	315	400	315	-	-	1030
547	547...586.9	L-428	-	315	400	400	-	-	1115
587	587...627	L-428	-	315	400	400	-	-	1115

- 1) Nomenclature differences between older and newer nozzle series result from the revision of the nozzle range.
- 2) Depending on the nozzle series, the length code corresponds either to a particular nozzle length or to a range of lengths.
- 3) The numbering of the heating zones starts at the nozzle tip and ends at the nozzle head.

You can configure your nozzle here

1. Complete the nozzle description ¹⁾

12 E01 W01T
Series & Type ↑ Length code ↑

2. Selection of variables

L=↑* H=↑
*can be chosen within range shown in table below

Example and explanations

Series ↓ Position in nozzle length chart ²⁾ ↓
12 E01 W01T **100**
Series & Type ↑ Type ¹⁾ ↑ Length code ↑

- W Nozzle tip shape W
- 01 Version 01: for materials with medium to wide process window
- T Gating type T: open with torpedo

112 3.6
L=↑ H=↑
↑ Variables for precise nozzle specification from the drawings and tables shown here

H (mm)					
2.1	2.4	2.7	3.0	3.3	3.6

Illustrations simplified, schematically drawn and not to scale.

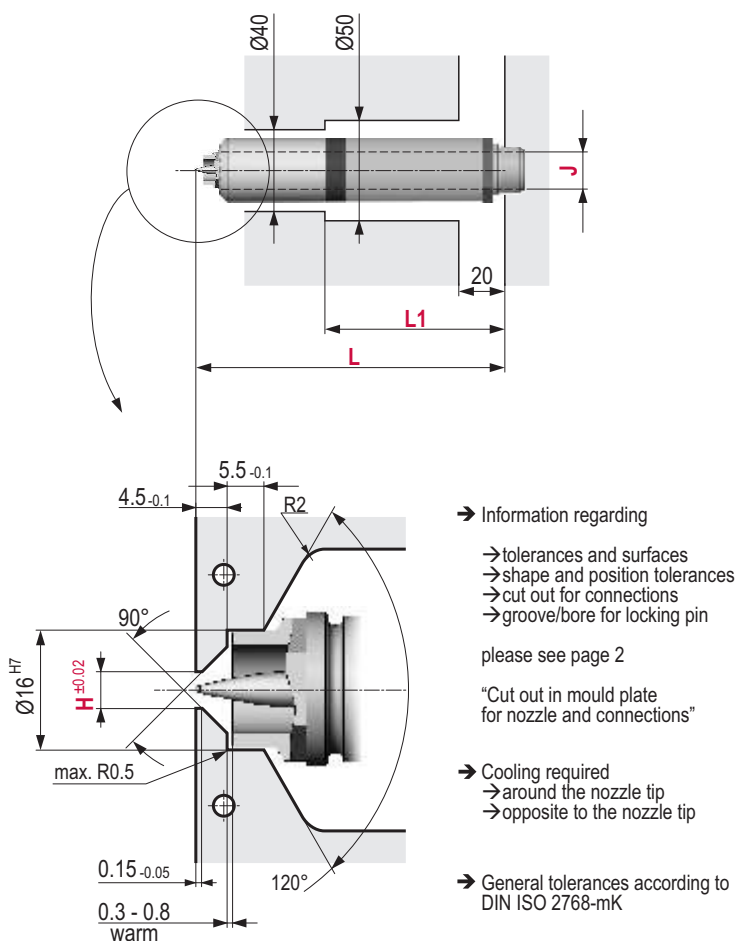

- Information regarding
 - tolerances and surfaces
 - shape and position tolerances
 - cut out for connections
 - groove/bore for locking pin
- please see page 2
- "Cut out in mould plate for nozzle and connections"
- Cooling required
 - around the nozzle tip
 - opposite to the nozzle tip
- General tolerances according to DIN ISO 2768-mK

Length code	L (mm)	L1 (mm)	L2 (mm)	Heater zones power ³⁾ (Watt)					1...5
				1	2	3	4	5	
100	100...199.9	-	-	315	-	-	-	-	315
120	120...139.9	-	-	315	140	-	-	-	455
140	140...159.9	-	-	315	-	-	-	-	315
160	159...179.9	-	-	315	140	-	-	-	455
180	180...199.9	-	-	400	-	-	-	-	400
200	200...219.9	-	-	400	140	-	-	-	540
220	220...259.9	-	-	315	315	-	-	-	630
260	260...299.9	-	-	315	315	-	-	-	630
300	300...339.9	-	-	315	400	-	-	-	715
340	340...379.9	-	-	315	400	-	-	-	715
380	380...419.9	-	-	315	400	180	-	-	895
420	420...459.9	0 / L-421	-	315	400	250	-	-	965
460	460...499.9	L-421	-	315	400	315	-	-	1030
500	500...539.9	L-421	-	315	400	315	-	-	1030
540	540...579.9	L-421	-	315	400	400	-	-	1115
580	580...620	L-421	-	315	400	400	-	-	1115

1) Nomenclature differences between older and newer nozzle series result from the revision of the nozzle range.
2) Depending on the nozzle series, the length code corresponds either to a particular nozzle length or to a range of lengths.
3) The numbering of the heating zones starts at the nozzle tip and ends at the nozzle head.

Illustrations simplified, schematically drawn and not to scale.

You can configure your nozzle here

1. Complete the nozzle description ¹⁾

12 E01 W01V

Series & Type ↑ Length code ↑

2. Selection of variables

L=↑* H=↑

*can be chosen within range shown in table below

Example and explanations

Series

Position in nozzle length chart ²⁾

12 E01 W01V

100

Series & Type ↑ Length code ↑

Type ¹⁾

W Nozzle tip shape W

01 Version 01: for materials with medium to wide process window

V Gating type V: valve gate

112 4.0

L=↑ H=↑

↑ Variables for precise nozzle specification from the drawings and tables shown here

H (mm)
4.0

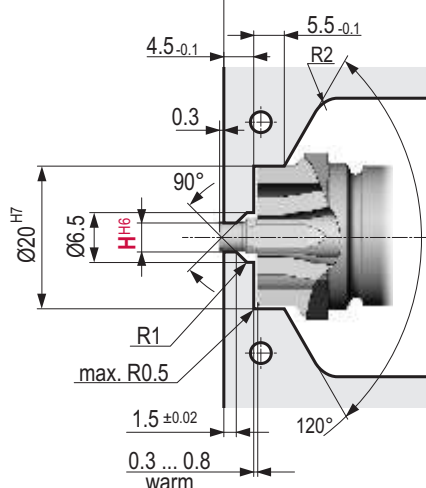
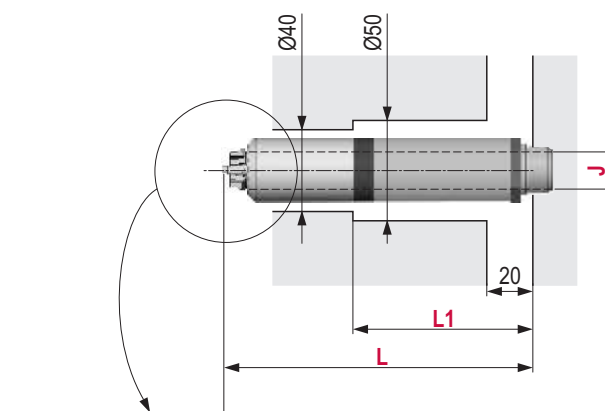

- Information regarding
 - tolerances and surfaces
 - shape and position tolerances
 - cut out for connections
 - groove/bore for locking pin

please see page 2

"Cut out in mould plate for nozzle and connections"

- Cooling required
 - around the nozzle tip
 - opposite to the nozzle tip

- General tolerances according to DIN ISO 2768-mK

Length code	L (mm)	L1 (mm)	L2 (mm)	Heater zones power ³⁾ (Watt)					1...5
				1	2	3	4	5	
100	100...199.9	-	-	315	-	-	-	-	315
120	120...139.9	-	-	315	140	-	-	-	455
140	140...159.9	-	-	315	-	-	-	-	315
160	159...179.9	-	-	315	140	-	-	-	455
180	180...199.9	-	-	400	-	-	-	-	400
200	200...219.9	-	-	400	140	-	-	-	540
220	220...259.9	-	-	315	315	-	-	-	630
260	260...299.9	-	-	315	315	-	-	-	630
300	300...339.9	-	-	315	400	-	-	-	715
340	340...379.9	-	-	315	400	-	-	-	715
380	380...419.9	-	-	315	400	180	-	-	895
420	420...459.9	0 / L-421	-	315	400	250	-	-	965
460	460...499.9	L-421	-	315	400	315	-	-	1030
500	500...539.9	L-421	-	315	400	315	-	-	1030
540	540...579.9	L-421	-	315	400	400	-	-	1115
580	580...620	L-421	-	315	400	400	-	-	1115

1) Nomenclature differences between older and newer nozzle series result from the revision of the nozzle range.
 2) Depending on the nozzle series, the length code corresponds either to a particular nozzle length or to a range of lengths.
 3) The numbering of the heating zones starts at the nozzle tip and ends at the nozzle head.

Illustrations simplified, schematically drawn and not to scale.

You can configure your nozzle here

1. Complete the nozzle description ¹⁾

12 E01 W02V

Series & Type ↑ Length code ↑

2. Selection of variables

L=↑* H=↑

*can be chosen within range shown in table below

Example and explanations

Series ↓ Position in nozzle length chart ²⁾ ↓

12 E01 W02V

103

Series & Type ↑ Type ¹⁾ ↑ Length code ↑

- W Nozzle tip shape W
- 02 Version 02:
→ for wide process window
→ when installation space is limited
- V Gating type V: valve gate

112 4.0

L=↑ H=↑

↑ Variables for precise nozzle specification from the drawings and tables shown here

H (mm)
4.0

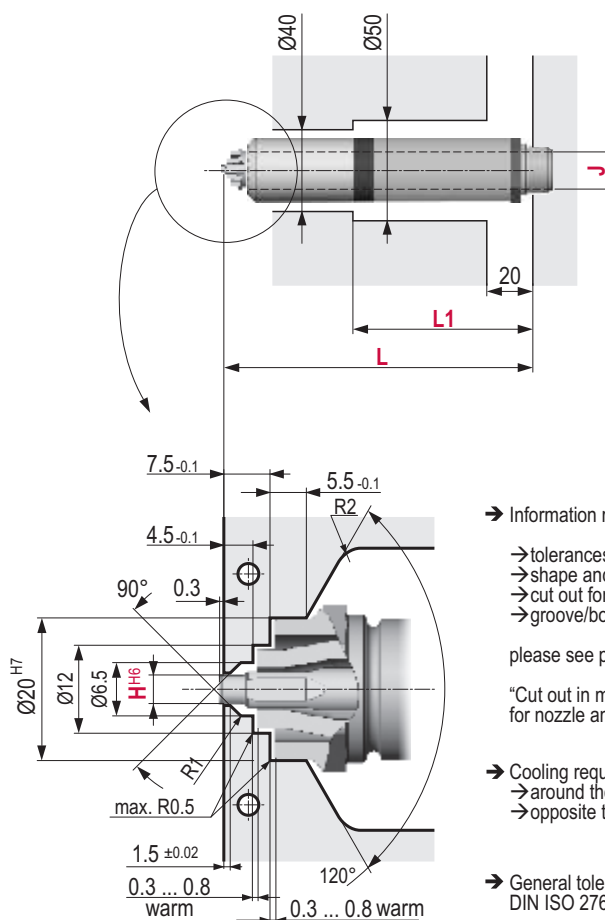

- Information regarding
 - tolerances and surfaces
 - shape and position tolerances
 - cut out for connections
 - groove/bore for locking pin
- please see page 2
- "Cut out in mould plate for nozzle and connections"
- Cooling required
 - around the nozzle tip
 - opposite to the nozzle tip
- General tolerances according to DIN ISO 2768-mK

1) Nomenclature differences between older and newer nozzle series result from the revision of the nozzle range.
 2) Depending on the nozzle series, the length code corresponds either to a particular nozzle length or to a range of lengths.
 3) The numbering of the heating zones starts at the nozzle tip and ends at the nozzle head.

Length code	L (mm)	L1 (mm)	L2 (mm)	Heater zones power ³⁾ (Watt)					1...5
				1	2	3	4	5	
103	103...122.9	-	-	315	-	-	-	-	315
123	123...142.9	-	-	315	140	-	-	-	455
143	143...162.9	-	-	315	-	-	-	-	315
163	163...182.9	-	-	315	140	-	-	-	455
183	183...202.9	-	-	400	-	-	-	-	400
203	203...222.9	-	-	400	140	-	-	-	540
223	223...262.9	-	-	315	315	-	-	-	630
263	263...302.9	-	-	315	315	-	-	-	630
303	303...342.9	-	-	315	400	-	-	-	715
343	343...382.9	-	-	315	400	-	-	-	715
383	383...422.9	-	-	315	400	180	-	-	895
423	423...462.9	0 / L-424	-	315	400	250	-	-	965
463	463...502.9	L-424	-	315	400	315	-	-	1030
503	503...542.9	L-424	-	315	400	315	-	-	1030
543	543...582.9	L-424	-	315	400	400	-	-	1115
583	583...623	L-424	-	315	400	400	-	-	1115

www.synventive.com

MK-PRM.BRM.GB-P.112E01 2009-05-01

 **Synventive**
molding solutions