

SR8SB

Single Nozzles, Support Ring

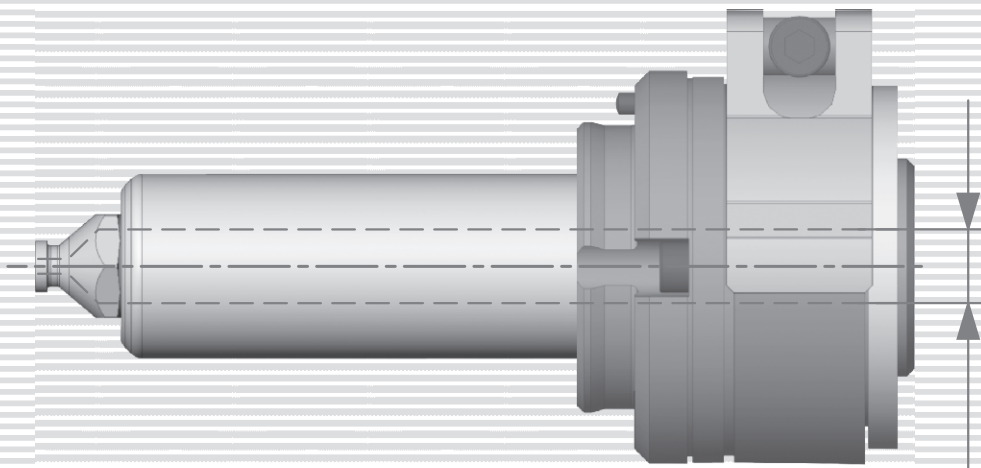

Ø8

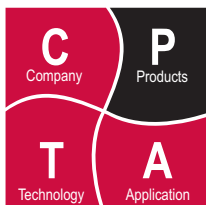

Product type

Hot runner nozzle, SR (support ring)
→ Replaceable threaded tips

Available with four Controlled Vestige (CV) tip options including valve gates for zero vestige applications. See table at right.

Available gating types
→ Cone point

Illustrations simplified, schematically drawn and not to scale.

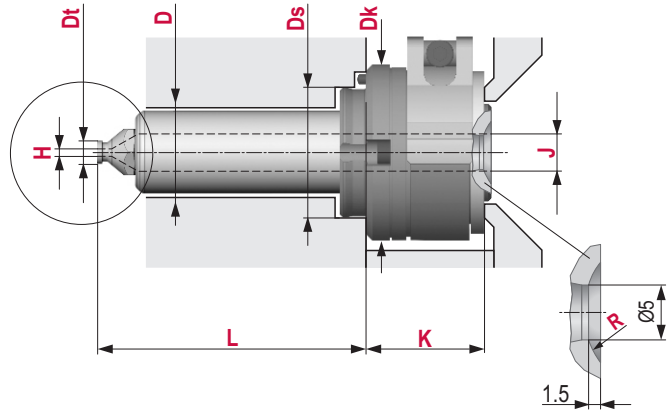

Major Dimensions (mm)

L	Nozzle length	36...246 ^{1) 2)}
J	Nozzle flow bore	Ø8
D	Ø of cut out, front	Ø27
Dt	Centering Ø tip	Ø7
H	Gate Ø	See right
R	Nozzle contact radius	0...40
K	Head Height	36
Dk	Head Ø	Ø53
Ds	Ø of head centering	Ø40

Heating

→ Externally heated
→ Two replaceable long life heaters and thermocouple for operation

Application

For all usual thermoplastics
Max. shot weight per nozzle (g)
→ 150 (low viscosity)

Available tip styles for SR8 Nozzles
Gating of nozzle tip

Cone point thermal gate

Witness Mark	CV-11 H: Ø1.0-2.4 Dt: Ø7	CV-11D H: Ø1.0-2.4 Dt: Ø7
		CV-11E H: Ø1.6-2.7 Dt: Ø7
No Witness Mark	CV-21 H: Ø0.6-2.7 Dt: Ø7	

1) Raster dimensions. Intermediate values can be found from the prescribed dimensional raster.
2) Minimum and maximum value of nozzle length depend on the selected tip shape.

Illustrations simplified, schematically drawn and not to scale.

1. Cut out for the nozzle

J Length from back of cavity plate to Gate location

General tolerances: DIN ISO 2768-mK

Surfaces: $\nabla 3.2 / \left(\nabla 1.6 / \nabla 0.8 \right)$

Values of the dimension J can be found in the data sheet for the selected nozzle type.

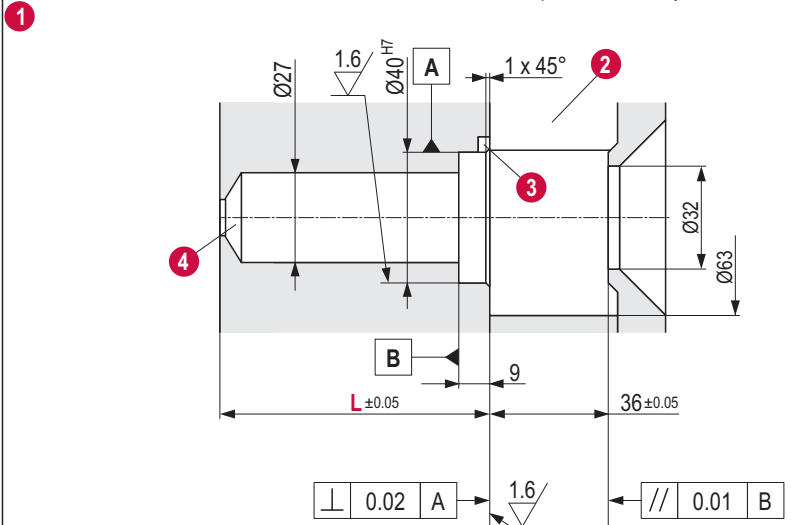

2. Cut out for connections

→ electrical power
→ thermocouple

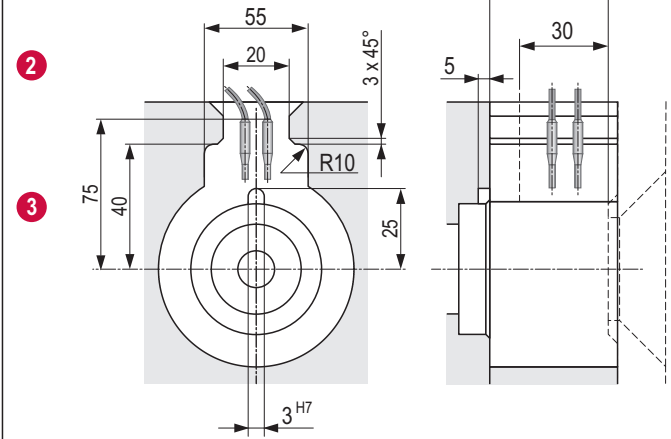

3. Alignment pin

The alignment pin prevents the nozzle from rotating.

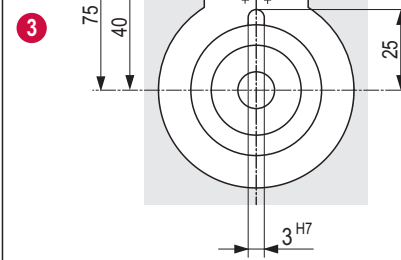

4. Cut out for the nozzle tip

- a) Through bore nozzle tip (CV11, CV11D, CV11E)
- b) Blind bore nozzle tip (CV21)

Dt Tip Ø
H Gate Ø

Depending on the selected nozzle type, different cut outs are required for the nozzle tip.

The dimensions of the cut out for the nozzle tip used can be found in the nozzle data sheet.

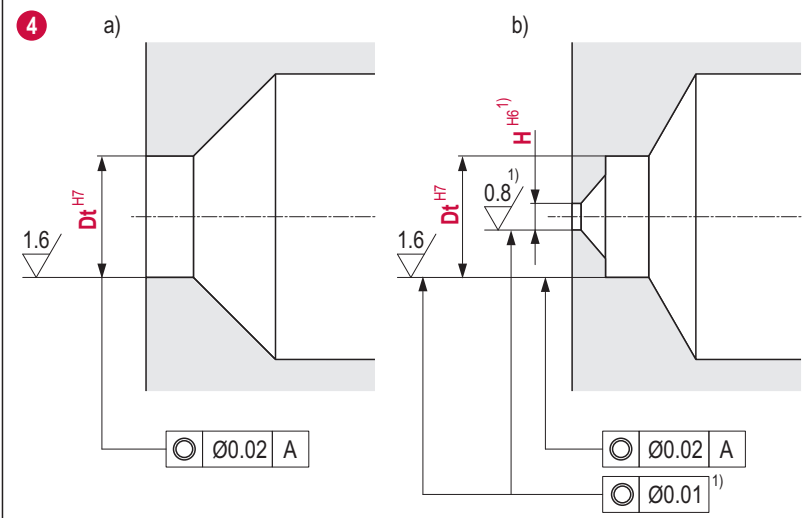

1) Applies to valve gate nozzles.

SR8SB CV11

General:

- Filled and unfilled materials
- More heat in gate area for semi-crystalline materials
- One heater operation for independent nozzle control.
- Long life replaceable heater and thermocouple.
- Cooling is required in the gate area.
- The front face of the tip must be in contact with plastic.

Lk is used to confirm the correct depth of the 90° angle. Lk is the distance from the support ring shoulder to a precision Ø12mm ball.

Ordering Information:

SR8SB036 CV11

- SR8SB - SR8 series nozzle
- 036 - Length
- CV11 - Tip Style

H = 1.0 R = 12.7

- H - Orifice diameter
- R - Nozzle contact radius

Illustrations simplified, schematically drawn and not to scale.

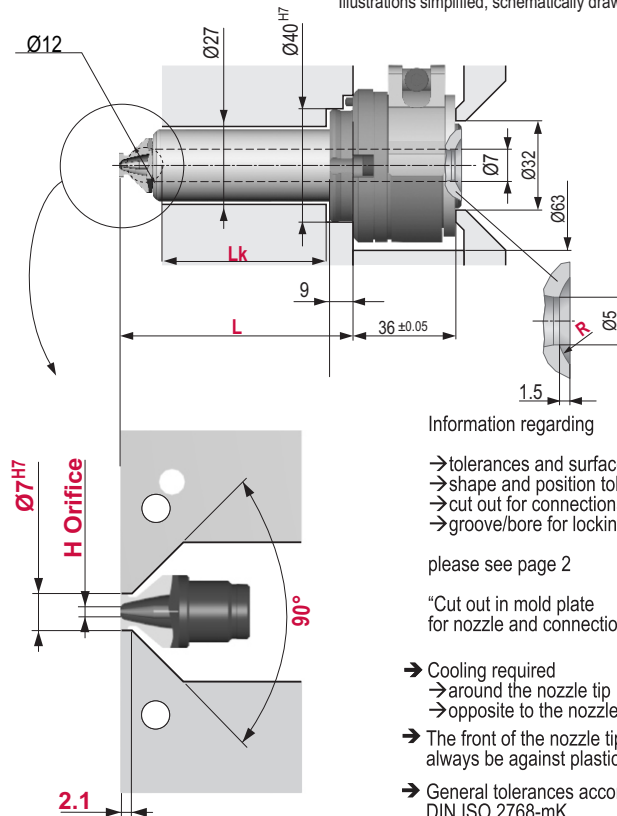

Information regarding

- tolerances and surfaces
- shape and position tolerances
- cut out for connections
- groove/bore for locking pin

please see page 2

"Cut out in mold plate for nozzle and connections"

- Cooling required
 - around the nozzle tip
 - opposite to the nozzle tip
- The front of the nozzle tip must always be against plastic.
- General tolerances according to DIN ISO 2768-mK

Part Number	L	Zone 1	Zone 2	Lk
SR8SB036 CV11	36	150W	315W	22.9
SR8SB046 CV11	46	150W	315W	32.9
SR8SB056 CV11	56	170W	315W	42.9
SR8SB066 CV11	66	170W	315W	52.9
SR8SB076 CV11	76	170W	315W	62.9
SR8SB086 CV11	86	185W	315W	72.9
SR8SB096 CV11	96	185W	315W	82.9
SR8SB106 CV11	106	185W	315W	92.9
SR8SB116 CV11	116	185W	315W	102.9
SR8SB126 CV11	126	220W	315W	112.9
SR8SB136 CV11	136	220W	315W	122.9
SR8SB146 CV11	146	220W	315W	132.9
SR8SB156 CV11	156	220W	315W	142.9
SR8SB166 CV11	166	250W	315W	152.9
SR8SB176 CV11	176	250W	315W	162.9
SR8SB186 CV11	186	250W	315W	172.9
SR8SB196 CV11	196	250W	315W	182.9
SR8SB206 CV11	206	280W	315W	192.9
SR8SB216 CV11	216	280W	315W	202.9
SR8SB226 CV11	226	280W	315W	212.9
SR8SB236 CV11	236	280W	315W	222.9
SR8SB246 CV11	246	280W	315W	232.9

SR8SB CV11D

- General:
- Filled and unfilled materials
 - More heat in gate area for semi-crystalline materials
 - One heater operation for independent nozzle control.
 - Long life replaceable heater and thermocouple.
 - Gate vestige remains below the part surface for unfilled materials.
 - Same as CV11 but with dimple.

Lk is used to confirm the correct depth of the 90° angle. Lk is the distance from the support ring shoulder to a precision Ø12mm ball.

Ordering Information:

- SR8SB036 CV11D**
 → SR8SB - SR8 series nozzle
 → 036 - Length
 → CV11D - Tip Style

- H = 1.0 R = 12.7**
 → H - Orifice diameter
 → R - Nozzle contact radius

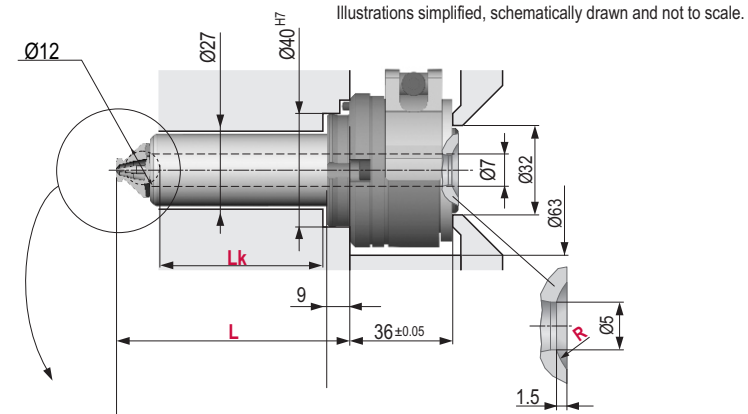

Illustrations simplified, schematically drawn and not to scale.

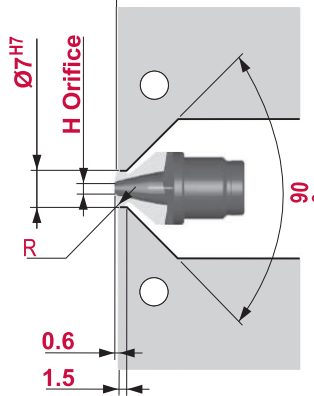

- Information regarding
- tolerances and surfaces
 - shape and position tolerances
 - cut out for connections
 - groove/bore for locking pin
- please see page 2
- "Cut out in mold plate for nozzle and connections"
- Cooling required
- around the nozzle tip
 - opposite to the nozzle tip
- The front of the nozzle tip must always be against plastic.
 - General tolerances according to DIN ISO 2768-mK

Part Number	L	Zone 1	Zone 2	Lk
SR8SB036 CV11D	36	150W	315W	22.9
SR8SB046 CV11D	46	150W	315W	32.9
SR8SB056 CV11D	56	170W	315W	42.9
SR8SB066 CV11D	66	170W	315W	52.9
SR8SB076 CV11D	76	170W	315W	62.9
SR8SB086 CV11D	86	185W	315W	72.9
SR8SB096 CV11D	96	185W	315W	82.9
SR8SB106 CV11D	106	185W	315W	92.9
SR8SB116 CV11D	116	185W	315W	102.9
SR8SB126 CV11D	126	220W	315W	112.9
SR8SB136 CV11D	136	220W	315W	122.9
SR8SB146 CV11D	146	220W	315W	132.9
SR8SB156 CV11D	156	220W	315W	142.9
SR8SB166 CV11D	166	250W	315W	152.9
SR8SB176 CV11D	176	250W	315W	162.9
SR8SB186 CV11D	186	250W	315W	172.9
SR8SB196 CV11D	196	250W	315W	182.9
SR8SB206 CV11D	206	280W	315W	192.9
SR8SB216 CV11D	216	280W	315W	202.9
SR8SB226 CV11D	226	280W	315W	212.9
SR8SB236 CV11D	236	280W	315W	222.9
SR8SB246 CV11D	246	280W	315W	232.9

SR8SB CV11E

- General:
- Filled and unfilled materials
 - One heater operation for independent nozzle control.
 - Long life replaceable heater and thermocouple.
 - Tip extension for gating on part contours.

Lk is used to confirm the correct depth of the 90° angle. Lk is the distance from the support ring shoulder to a precision Ø12mm ball.

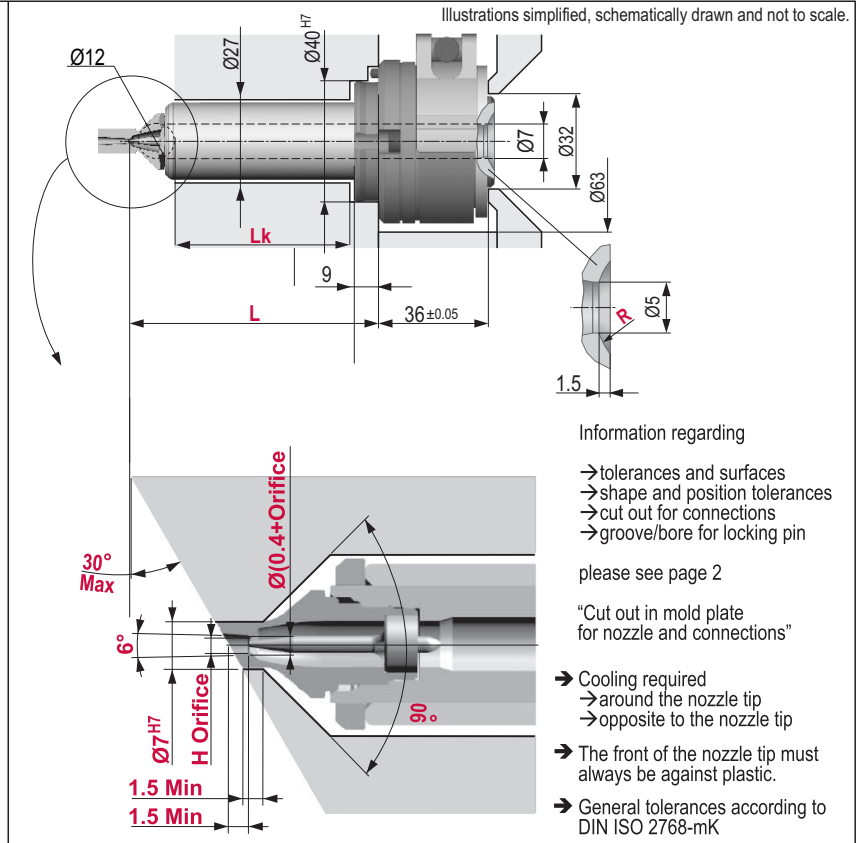

Ordering Information:

- SR8SB036 CV11E
- SR8SB - SR8 series nozzle
 - 036 - Length
 - CV11E - Tip Style

- H = 1.6 R = 12.7
- H - Orifice diameter
 - R - Nozzle contact radius

Part Number	L	Zone 1	Zone 2	Lk
SR8SB036 CV11E	36	150W	315W	22.9
SR8SB046 CV11E	46	150W	315W	32.9
SR8SB056 CV11E	56	170W	315W	42.9
SR8SB066 CV11E	66	170W	315W	52.9
SR8SB076 CV11E	76	170W	315W	62.9
SR8SB086 CV11E	86	185W	315W	72.9
SR8SB096 CV11E	96	185W	315W	82.9
SR8SB106 CV11E	106	185W	315W	92.9
SR8SB116 CV11E	116	185W	315W	102.9
SR8SB126 CV11E	126	220W	315W	112.9
SR8SB136 CV11E	136	220W	315W	122.9
SR8SB146 CV11E	146	220W	315W	132.9
SR8SB156 CV11E	156	220W	315W	142.9
SR8SB166 CV11E	166	250W	315W	152.9
SR8SB176 CV11E	176	250W	315W	162.9
SR8SB186 CV11E	186	250W	315W	172.9
SR8SB196 CV11E	196	250W	315W	182.9
SR8SB206 CV11E	206	280W	315W	192.9
SR8SB216 CV11E	216	280W	315W	202.9
SR8SB226 CV11E	226	280W	315W	212.9
SR8SB236 CV11E	236	280W	315W	222.9
SR8SB246 CV11E	246	280W	315W	232.9

SR8SB CV21

General:

- Filled and unfilled materials
- More heat in gate area for semi-crystalline materials
- One heater operation for independent nozzle control.
- Long life replaceable heater and thermocouple.
- No witness mark on part.

Gate Style A:

- Standard gate geometry
- Thermoplastics with a medium to wide processing window.

Gate Style B:

- Improved color change.

For optimum color change a secondary parting line is recommended to allow easy removal of plastic insulating cap.

Lk is used to confirm the correct depth of the 90° angle. Lk is the distance from the support ring shoulder to a precision Ø12mm ball.

Ordering Information:

SR8SB036 CV21

- SR8SB - SR8 series nozzle
- 036 - Length
- CV21 - Tip Style

H = 1.0 R = 12.7

- H - Orifice diameter
- R - Nozzle contact radius

Illustrations simplified, schematically drawn and not to scale.

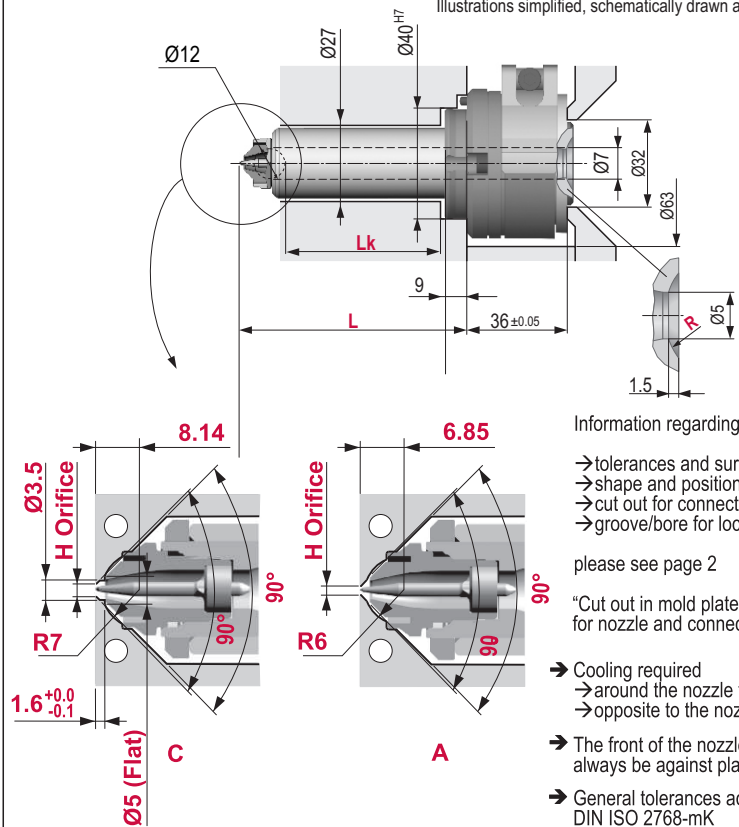

Part Number	L	Zone 1	Zone 2	Lk
SR8SB036 CV21	36	150W	315W	22.9
SR8SB046 CV21	46	150W	315W	32.9
SR8SB056 CV21	56	170W	315W	42.9
SR8SB066 CV21	66	170W	315W	52.9
SR8SB076 CV21	76	170W	315W	62.9
SR8SB086 CV21	86	185W	315W	72.9
SR8SB096 CV21	96	185W	315W	82.9
SR8SB106 CV21	106	185W	315W	92.9
SR8SB116 CV21	116	185W	315W	102.9
SR8SB126 CV21	126	220W	315W	112.9
SR8SB136 CV21	136	220W	315W	122.9
SR8SB146 CV21	146	220W	315W	132.9
SR8SB156 CV21	156	220W	315W	142.9
SR8SB166 CV21	166	250W	315W	152.9
SR8SB176 CV21	176	250W	315W	162.9
SR8SB186 CV21	186	250W	315W	172.9
SR8SB196 CV21	196	250W	315W	182.9
SR8SB206 CV21	206	280W	315W	192.9
SR8SB216 CV21	216	280W	315W	202.9
SR8SB226 CV21	226	280W	315W	212.9
SR8SB236 CV21	236	280W	315W	222.9
SR8SB246 CV21	246	280W	315W	232.9